



KANGAROO™
sewing furniture

ASSEMBLY INSTRUCTIONS

Wallaby II

ITEM NO.: K8405 Teak
K8411 White Ash

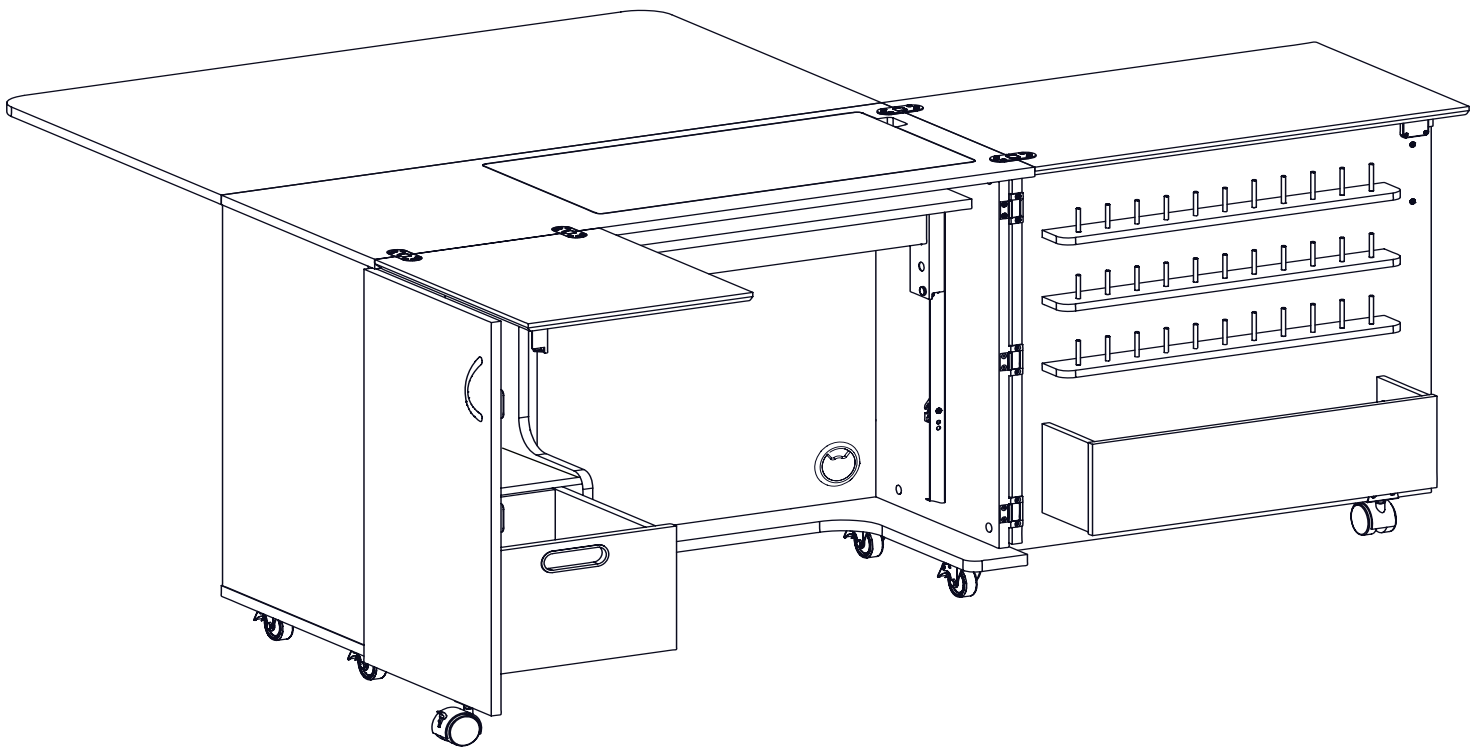

SEW IN COMFORT. SEW LONGER.™

Read the instructions carefully before starting. Please open and inspect the contents of boxes to see that all parts are included. You will need a Phillips head and a flat head screwdriver. A power screwdriver or cordless drill is preferable. Ensure that the Phillips head fits neatly and fully engages the screw to avoid damage to the screws. Make sure that you tighten all screws securely and tap wooden dowels all the way in.

Use and Care

Your cabinet normally requires a minimum amount of maintenance; however, the following points are worth noting:

Cleaning - To remove marks and enhance the surface, wipe with general purpose cleaner.

Caution - Do not use ammonia-based cleaning agents. Do not use harsh chemicals or abrasive cleansers. The surface can be wiped with a damp cloth but should be dried quickly.

Electrical and Hydraulic Lifts - Require annual lubrication.

Understanding How the Cam Fastener Works

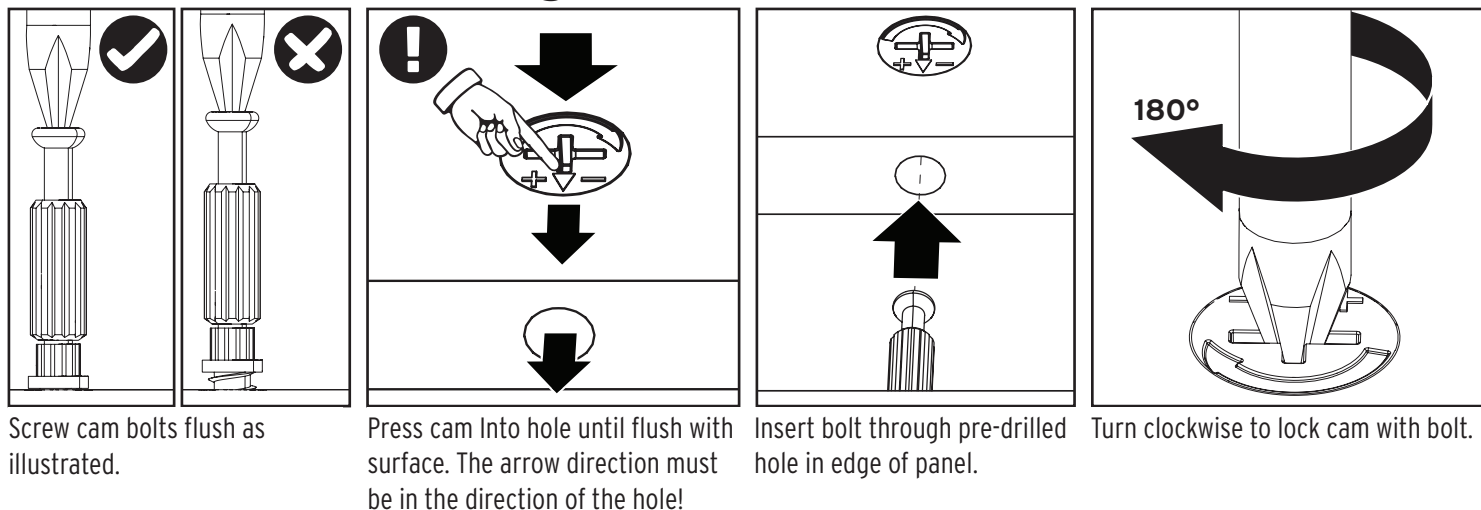

Parts List

ITEM	DESCRIPTION	QTY.	PACK.	ITEM	DESCRIPTION	QTY.	PACK.
A	Top Panel	1	1 of 4	V2b	Right Door Edge Panel	1	3 of 4
B	Right Leaf	1	1 of 4	L	Drawer Front	1	3 of 4
C	Left Leaf	1	1 of 4	L1	Drawer Side Left	1	3 of 4
A5	Platform Cover	1	1 of 4	L2	Drawer Side Right	1	3 of 4
G	Bottom Panel	1	1 of 4	L3	Drawer Back	1	3 of 4
D	Back Panel	1	2 of 4	L4	Drawer Bottom	1	3 of 4
Z	Right Side Panel	1	2 of 4	O	Insert Holder	1	3 of 4
A1	Quilt Extension Panel	1	2 of 4	O1	Gate Leg	1	3 of 4
V1	Left Door Panel	1	2 of 4	K1	Door Bin Front Panel	1	3 of 4
V2a	Right Main Door Panel	1	3 of 4	K2	Door Bin Bottom Panel	1	3 of 4
X	Left Side Panel	1	3 of 4	K3	Door Bin Sides	2	3 of 4
Y	Partition	1	3 of 4	K4	Fixed Shelf On Door	3	3 of 4
F	Fixed Shelf	1	3 of 4	A4	Platform	1	3 of 4
					Lift & Rails	1	4 of 4

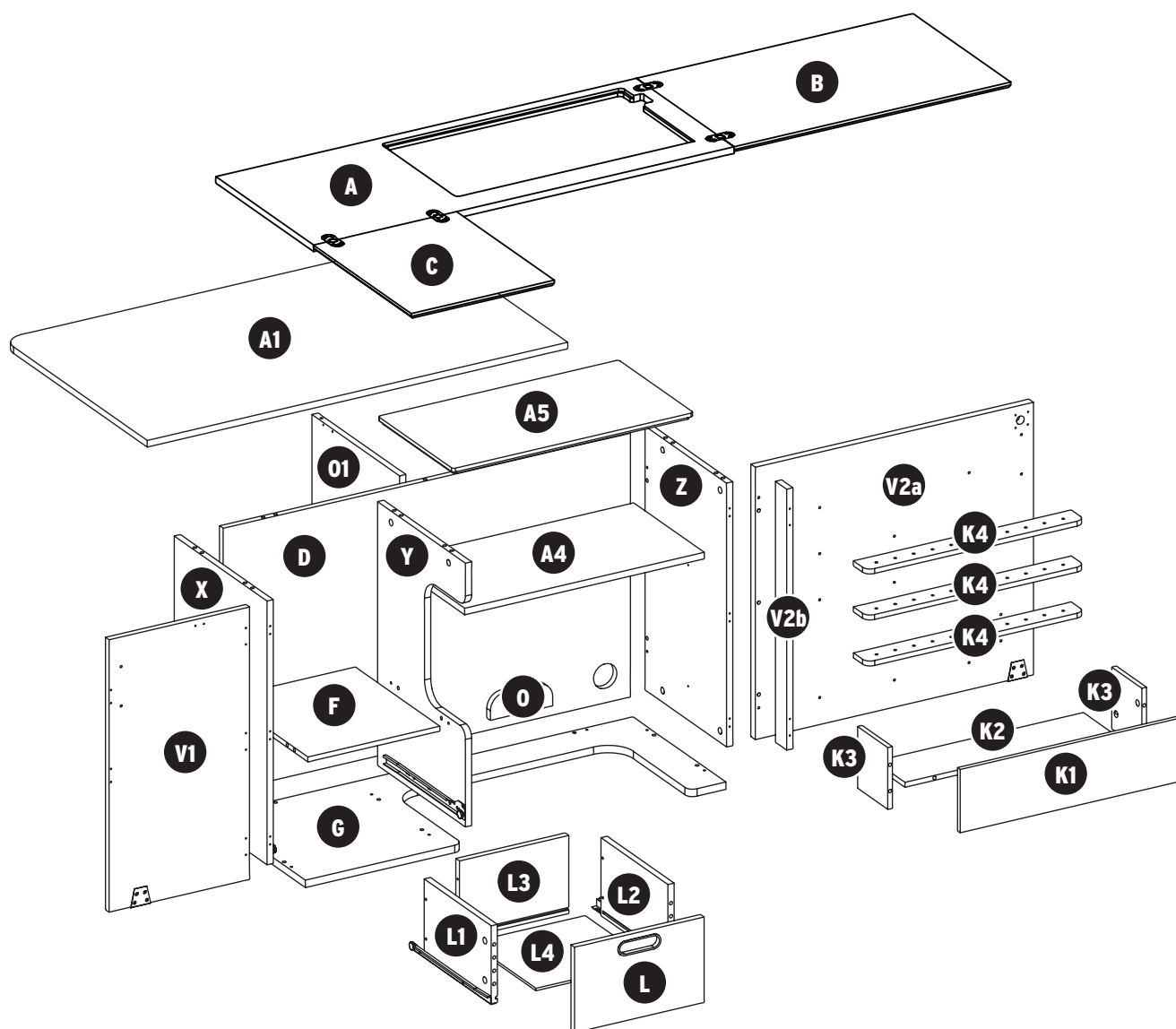

Parts List

ITEM	DESCRIPTION	QTY.	ITEM	DESCRIPTION	QTY.
c1	6x35 Cam Bolt	35	s3	3.5x35 Screw	4
c3	6x25 Cam Bolt	25	h	Handle	2
d1	8x30 Dowel Pin	36	h3	Flap Hinge	3
d2	6x50 Dowel Pin	33	h2	Flush Hinge	6
c2	$\frac{5}{8}$ " Cam Cover	60	b2	4x20 Fix Bolt	4
t2	Locking Plate Caster	5	b1	8x16 Fix Bolt	20
a	Wrench	1	s1	3.5x14 Screw	52
s2	3x14 Screw	28	m	Magnet, Catch Plate	1
S	Stay Arm	1	L	Lock, Lock Plate, Keyx2	1
r3	14mm Spanner	1	t1	Caster	3
d3	Door Plate	2	h1	Butt hinge	2
s5	Alignment Pin	1	s4	3x20 Screw	4

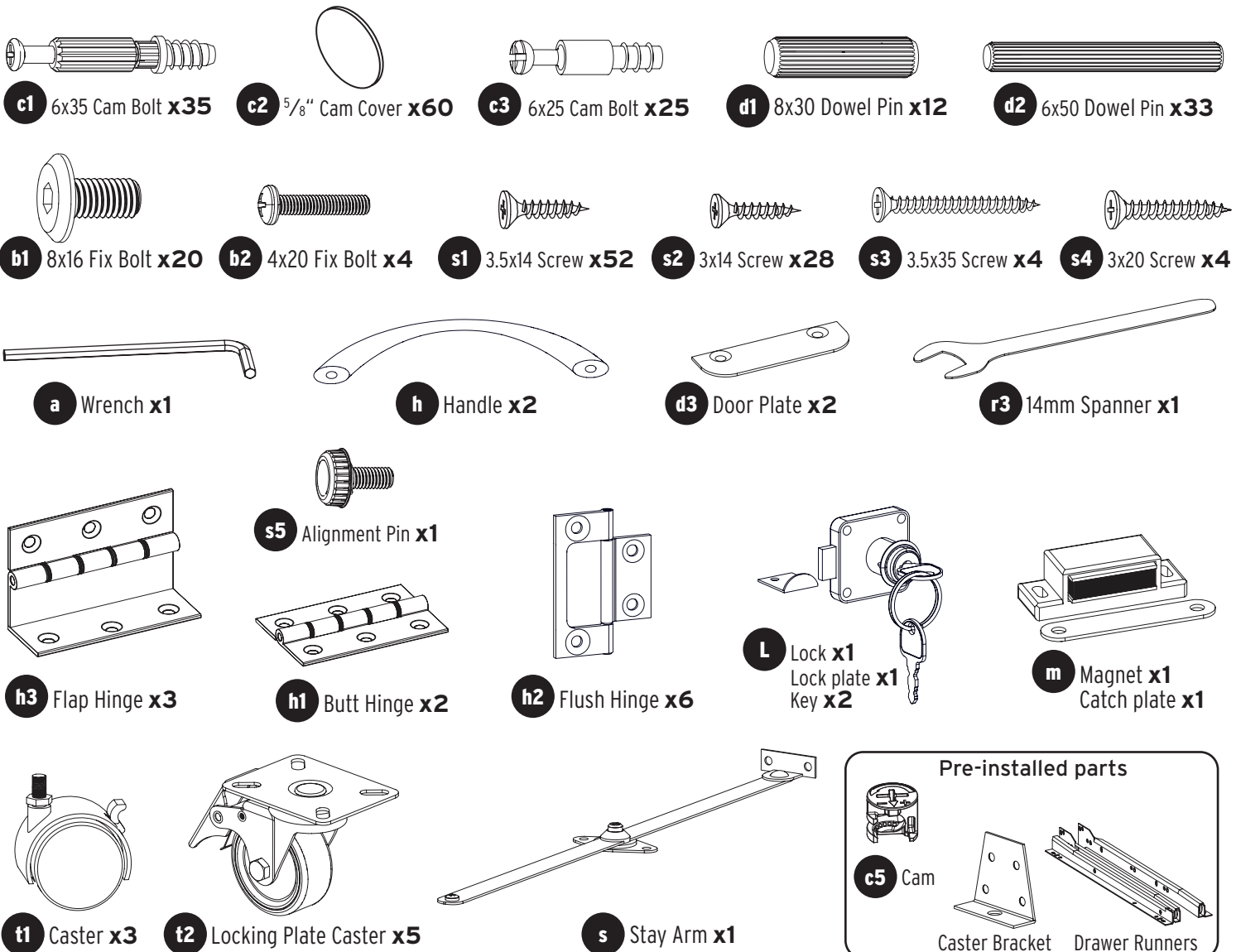

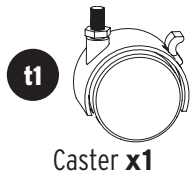
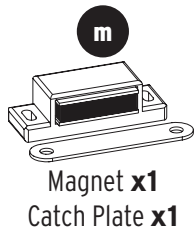
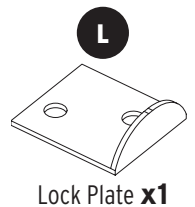
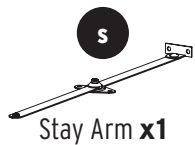
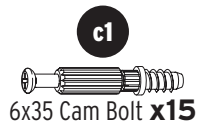

Step 1. Preparation Panels A, A1, Z, X, F and O1

1. Insert cams bolts **c1** into panels **A**, **X** and **Z** as illustrated below.
2. Insert dowel pins **d1** to panels **X**, **Z** and **F** as illustrated below..
3. Fix Stay Arm **s** using Screws **s1** to panel **A** as illustrated below.
4. Fix Lock Plate using Screws **s1** to panel **A** as illustrated below. Orient the flat face of lock plate **L** towards front edge of panel **A**.
5. Fix Magnet **m** using Screw **s1** to panels **A1** as illustrated below.
6. Fix Flap Hinge **h3** using Screw **s1** to panels **A1** as illustrated below.
7. Fix Butt hinges **h1** using Screws **s1** as shown on Panel **O1**. Insert the Alignment pin **s5**.
8. Insert the caster **t1** into the pre-installed caster bracket on panel **O1** and tighten with spanner **r3**.
9. Fix Catch plate **m** to panel **O1** using screws **s1**.

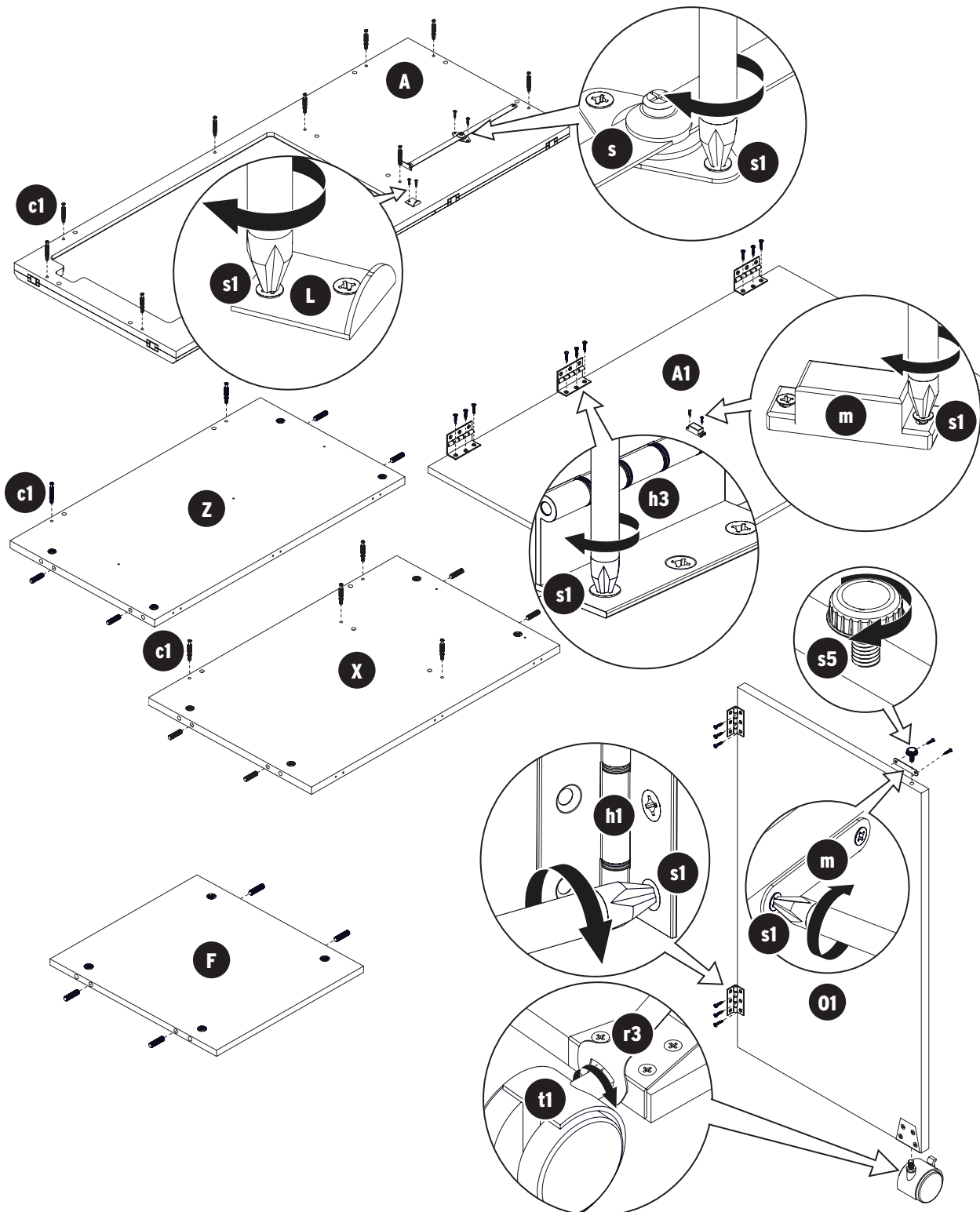

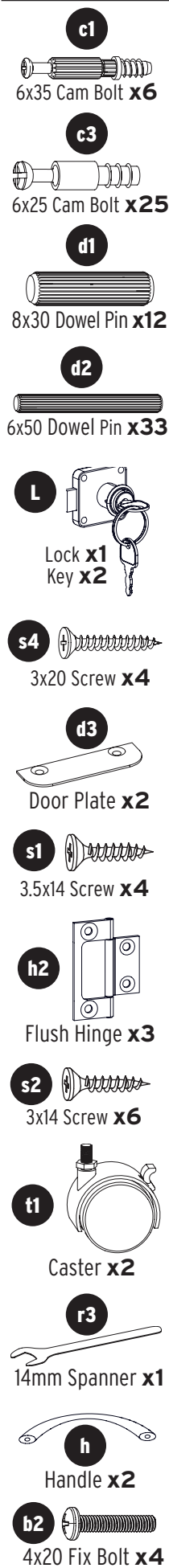

Step 2. Preparation Panels Y, D, O, V1, V2a, V2b, K1, K3, K4, L, L3 and L2

1. Insert cam bolts **c1** into panels **Y** and **V2a** and **L** as illustrated below.
2. Insert cam bolts **c3** into panels **V2a**, **K1** and **K3** as illustrated below.
3. Insert dowel pins **d1** into edges of panels **Y**, **D**, **V2b**, **L1** and **L2** using glue as illustrated below.
4. Insert dowel pins **d2** into top of panels **K4** using glue to secure.
5. Fix Lock mechanism **L** into corner of **V2a** using **s4** screws. Add trim ring to exterior end of lock.
6. Fix Door plate **d3** to panel **V1** using screws **s1**.
7. Attach Flush Hinges **h2** to panel **V1** using **s2** screws as shown.
8. Attach the screw-in caster to **V1** and **V2a** panel caster bracket and tighten with spanner **t1**.
9. Attach door handles **h** to exterior of **V1** and **V2a** using fix bolts **b2** as shown.

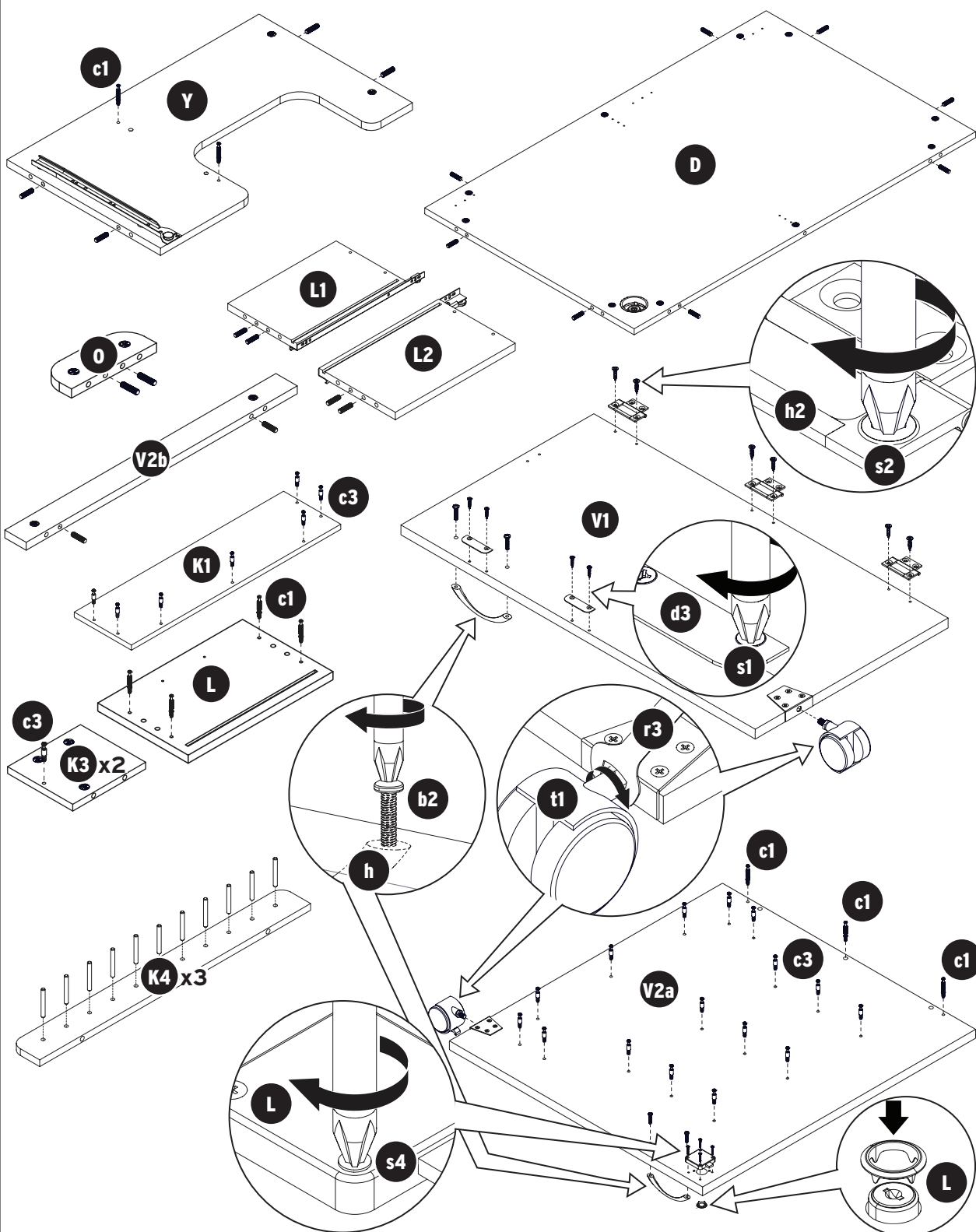

Step 3. Fix Lifter Rail (right) to Z panel with **s1** screws following predrilled holes as shown on the illustration below.

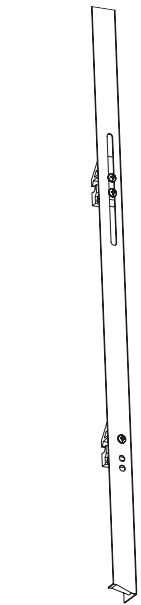

Lifter Rail (Right) **x1**

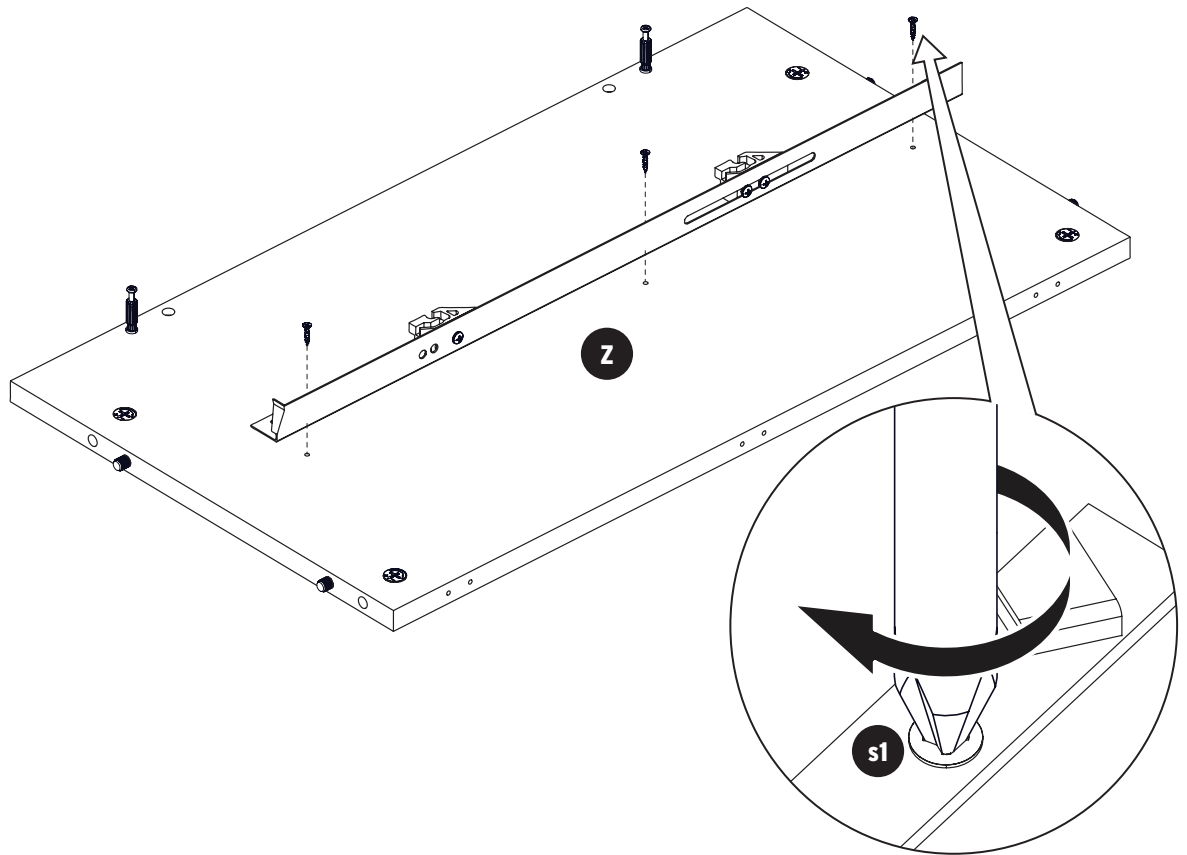

Step 4. Fix Lifter Rail (Left) to Y panel with **s1** screws following predrilled holes as shown on the illustration below.

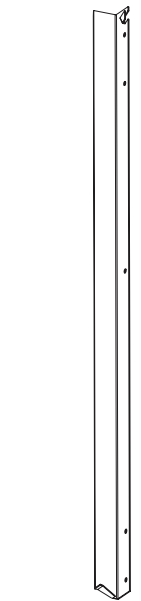

Lifter Rail (Left) **x1**

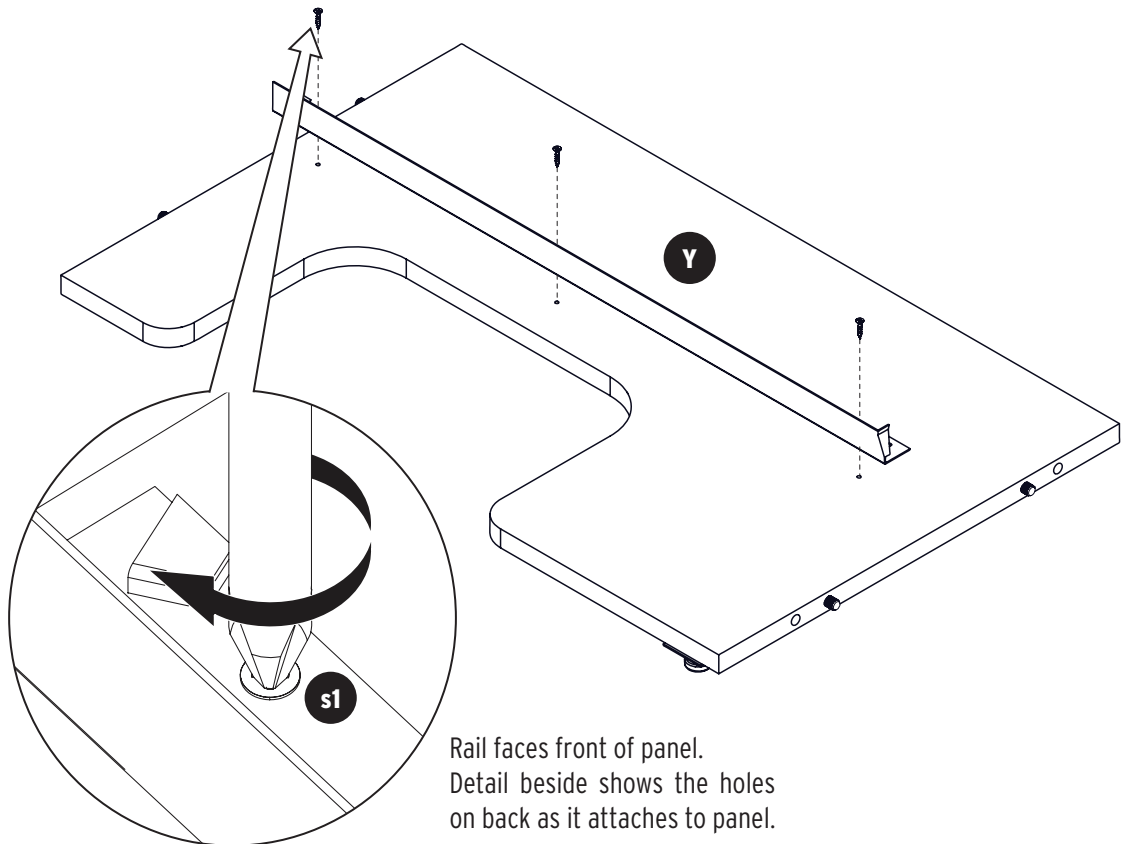

c2 $\frac{5}{8}$ " Cam Cover **x4****Step 5. Panels D, X, Z assembly.**

Insert cam bolts **c1** on panels **X** and **Z** into cams on panel **D** and tighten in a clockwise direction as illustrated below. Apply cam covers **c2** over tightened cams.

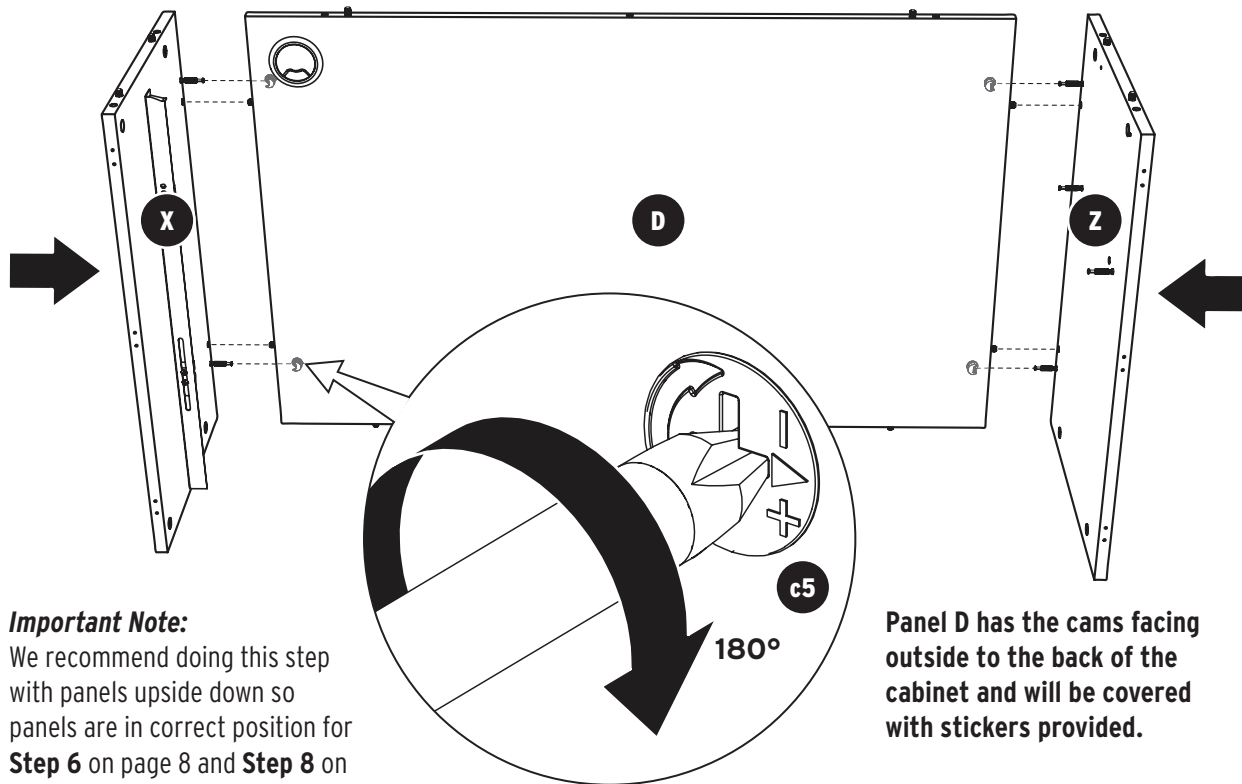
**Important Note:**

We recommend doing this step with panels upside down so panels are in correct position for **Step 6** on page 8 and **Step 8** on page 9.

Panel **D** has the cams facing outside to the back of the cabinet and will be covered with stickers provided.

c2 $\frac{5}{8}$ " Cam Cover **x4****Step 6. Panel F and Y assembly.**

Insert cam bolts **c1** on panels **X** and **Y** into cams on panel **F** and tighten in a clockwise direction as illustrated below. Apply cam covers **c2** over tightened cams.

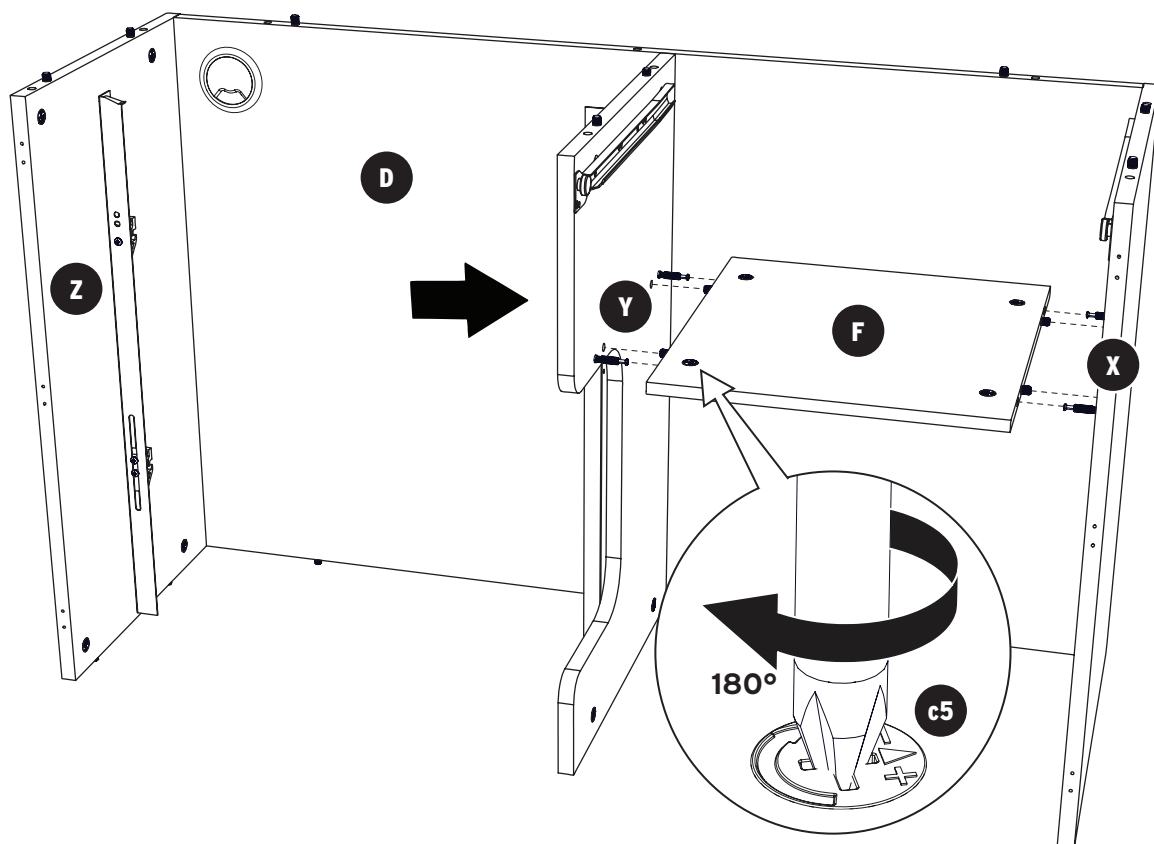

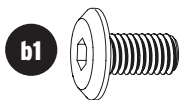

8x16 Fix Bolt **x20**

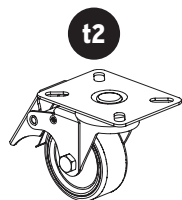

Locking Plate Caster **x5**



Wrench **x1**

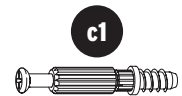

6x35 Cam Bolt **x11**

Step 7. Panel G assembly.

1. Fix casters **t2** to panel **G** with bolts **b1** as illustrated below.
2. Flip panel **G** over to top side. Install cam bolts **c1** as illustrated below.
3. Attach insert holder **O** by inserting cam bolts **c1** on panel **G** into **O** and tightening cams clockwise.

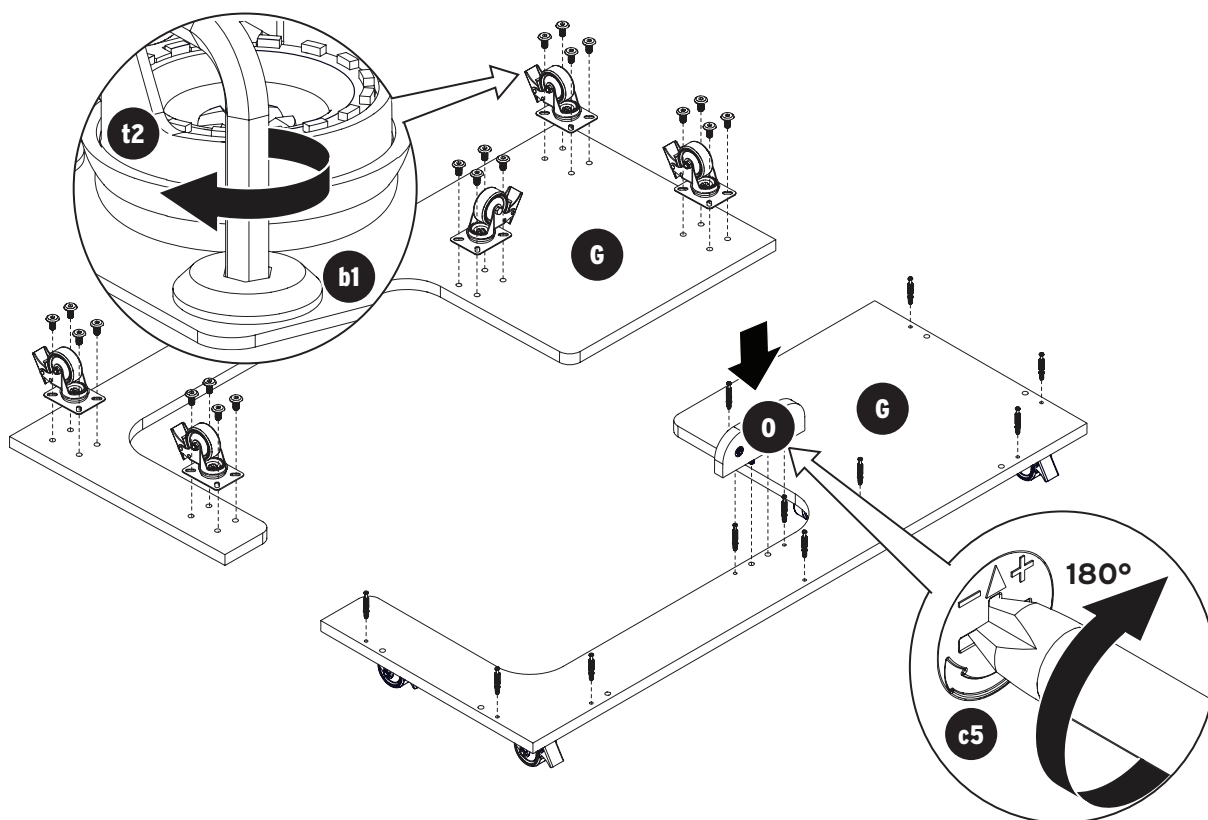

5/8" Cam Cover **x9**

Step 8. Panel G assembly.

1. Remove the drawer runners from panels **X** and **Y**.
2. Insert cam bolts **c1** on panel **G** into cams on panels **X**, **D**, **Y** and **Z** and tighten in a clockwise direction as illustrated below. Apply cam covers **c2** over tightened cams.
3. Attach the drawer runners on panels **X** and **Y**.

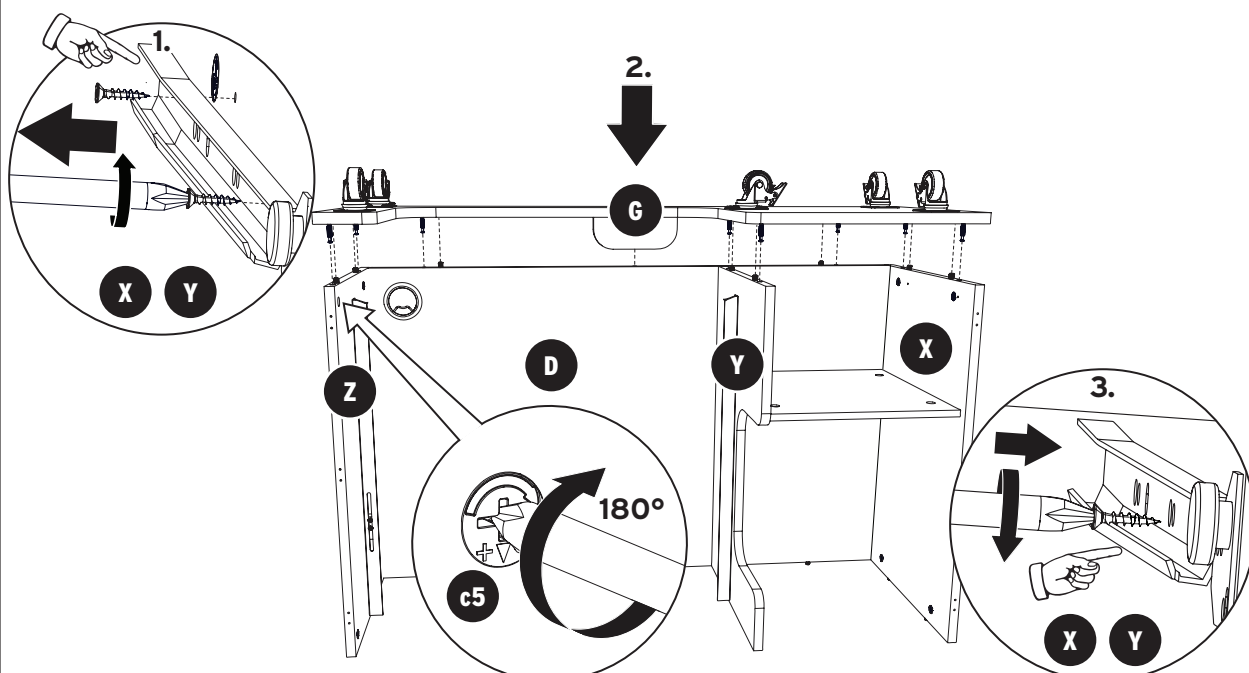

Step 9. Flip cabinet over (right side up).

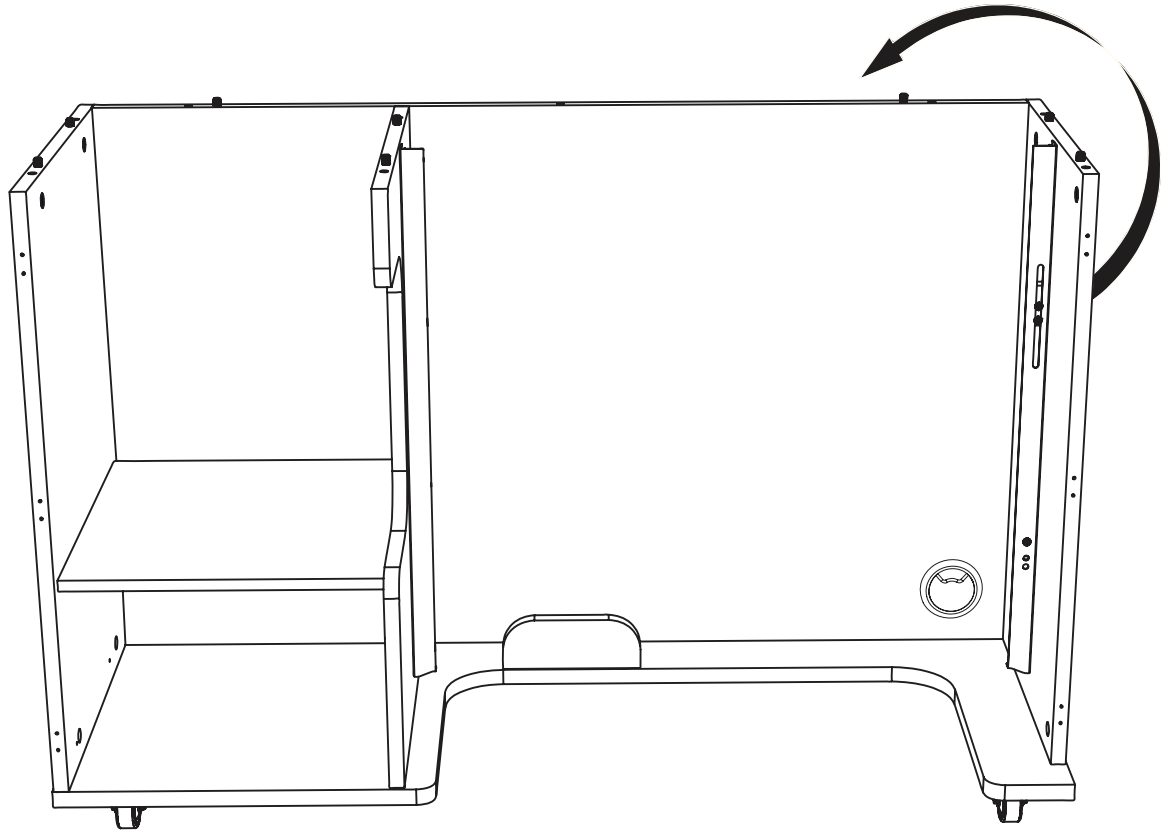

s1 
3.5x14 Screw **x4**

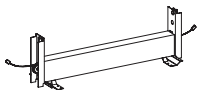
Lifter **x1**

Step 10. Lifter Panel assembly.

Fix Lifter to **A4** panel with **s1** screws following predrilled holes as shown on the illustration below.

Note: Remove cable ties (do not remove wooden block).

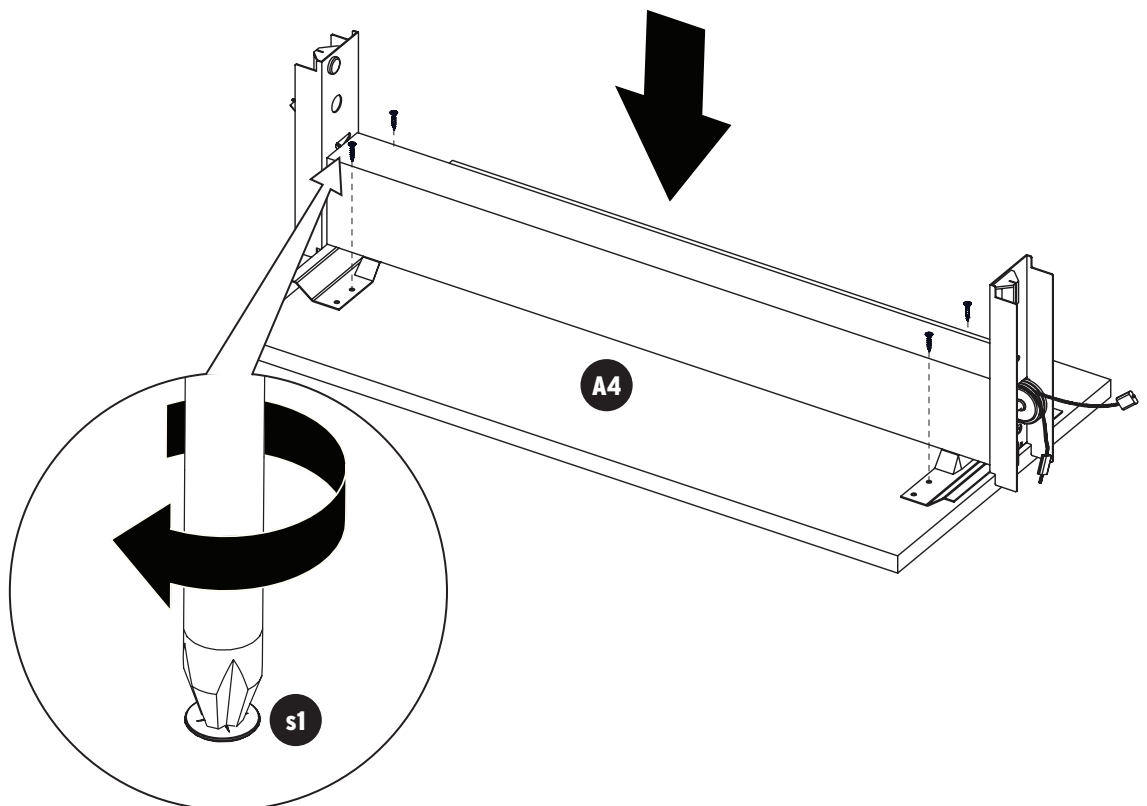

Step 11. Mounting the Lifter Assembly.

1. Position lifter onto side rails using plastic guides; make sure the cable is hooked into the rail tabs on both sides then lower the lift. See illustration below.
2. When lifter is pushed to first lock position remove a small wooden block that will be released from lifter.

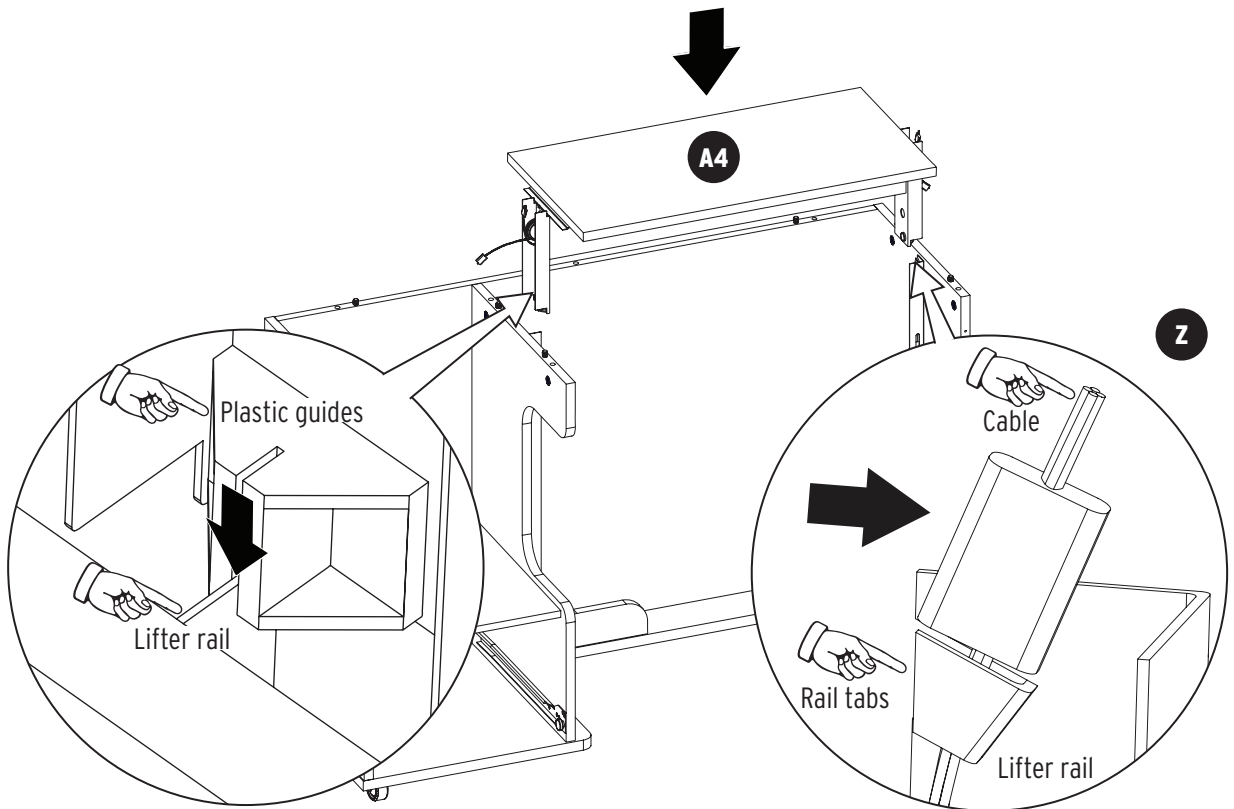

Step 12. Panel A assembly.

1. Insert cam bolts **c1** on panel **A** into cams on panels **X**, **D**, **Y** and **Z** and tighten in a clockwise direction as illustrated. Apply cam covers **c2** over tightened cams.

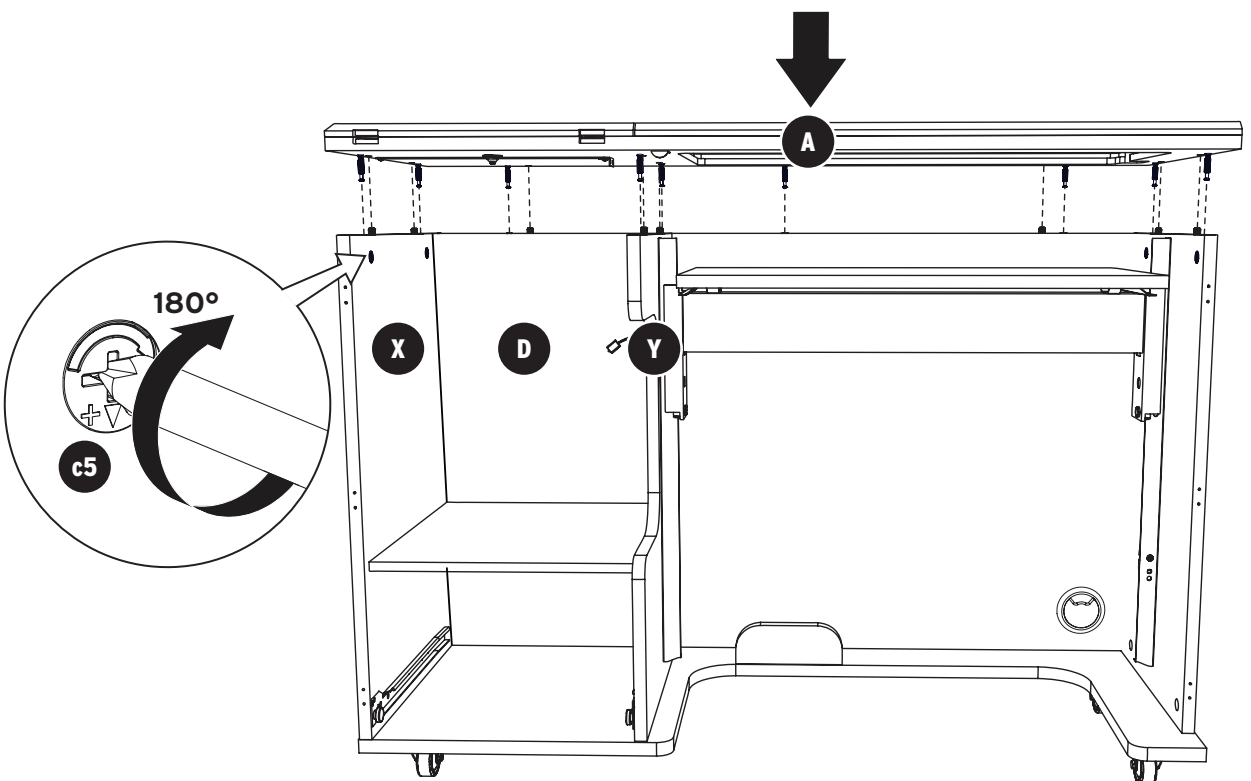
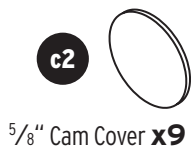

s33.5x35 Screw **x4****c2**5/8" Cam Cover **x4****Step 13. Drawer assembly.**

1. Insert cam bolts **c1** on panel **L** into cams on panels **L1** and **L2** and tighten in a clockwise direction as illustrated below.
Apply cam cover **c2** over tightened cams.
2. Slide bottom **L4** into **L**, **L1**, **L2** and **L3** grooves as illustrated.
3. Connect drawer panels **L1**, **L2** and **L3** with screws **s3** as illustrated below.
Apply cam cover **c2** over tightened cams.

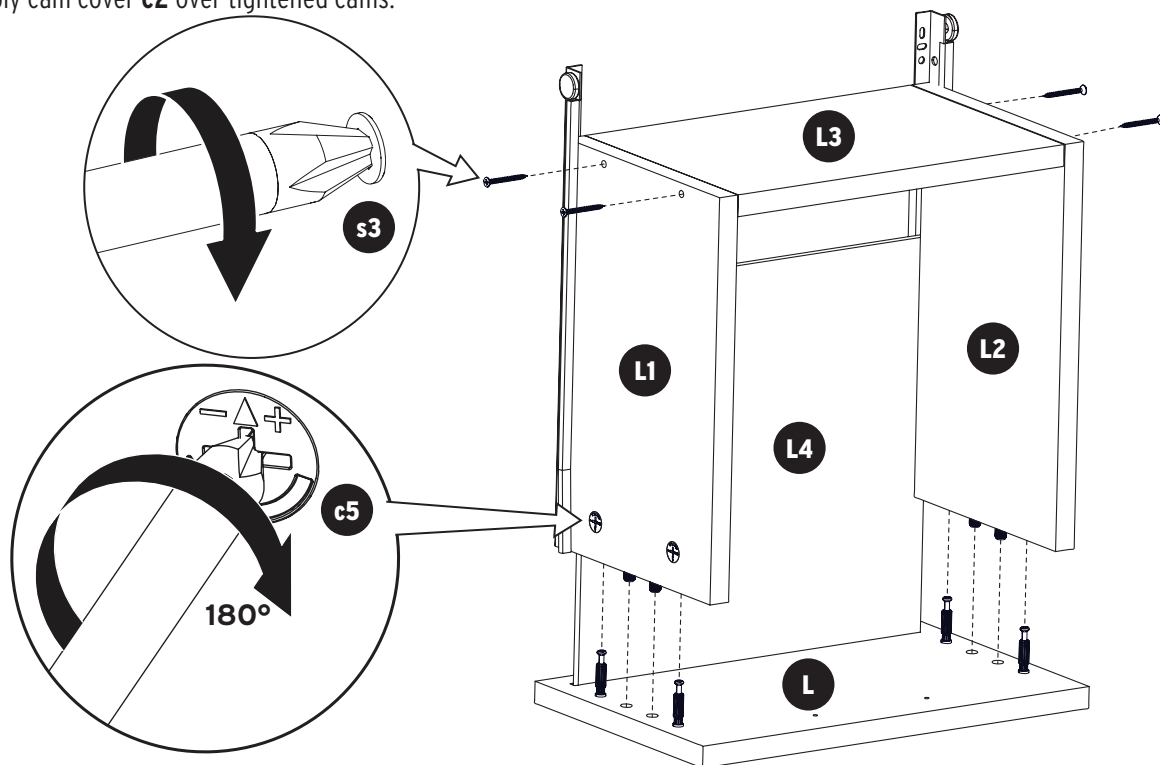
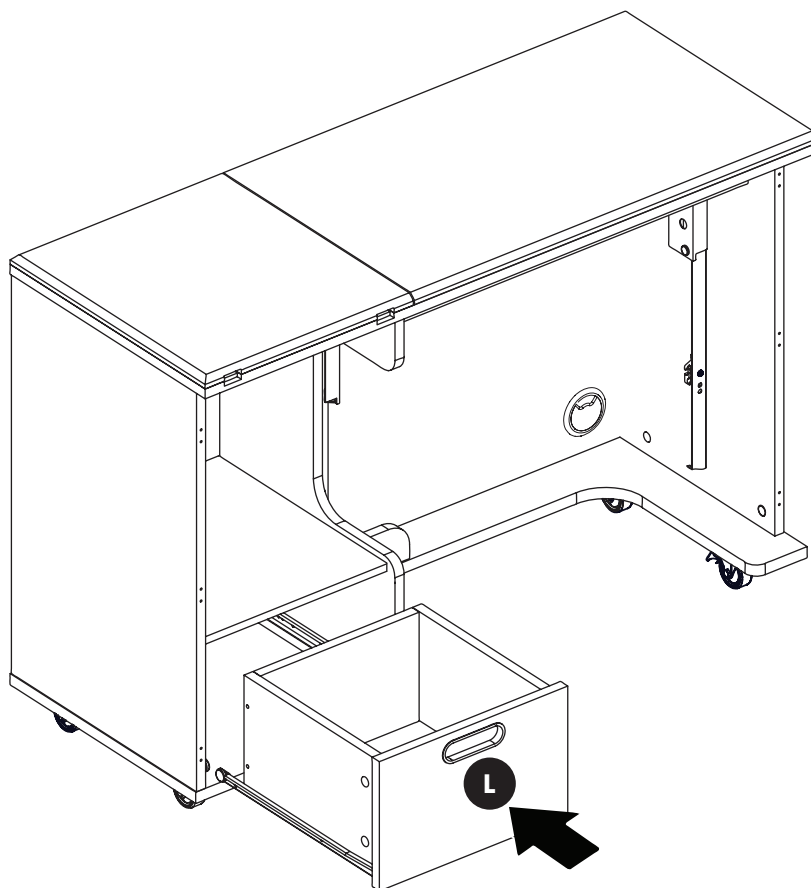
**Step 14. Drawer assembly.**

Step 15. Door Bin assembly.

1. Insert cam bolts on **K3** sides into cams in **K2** bottom panel and tighten cams in clockwise direction.
2. Insert cam bolts on **K1** front into cams in **K2** bottom panel and sides **K3** and tighten cams in clockwise direction.

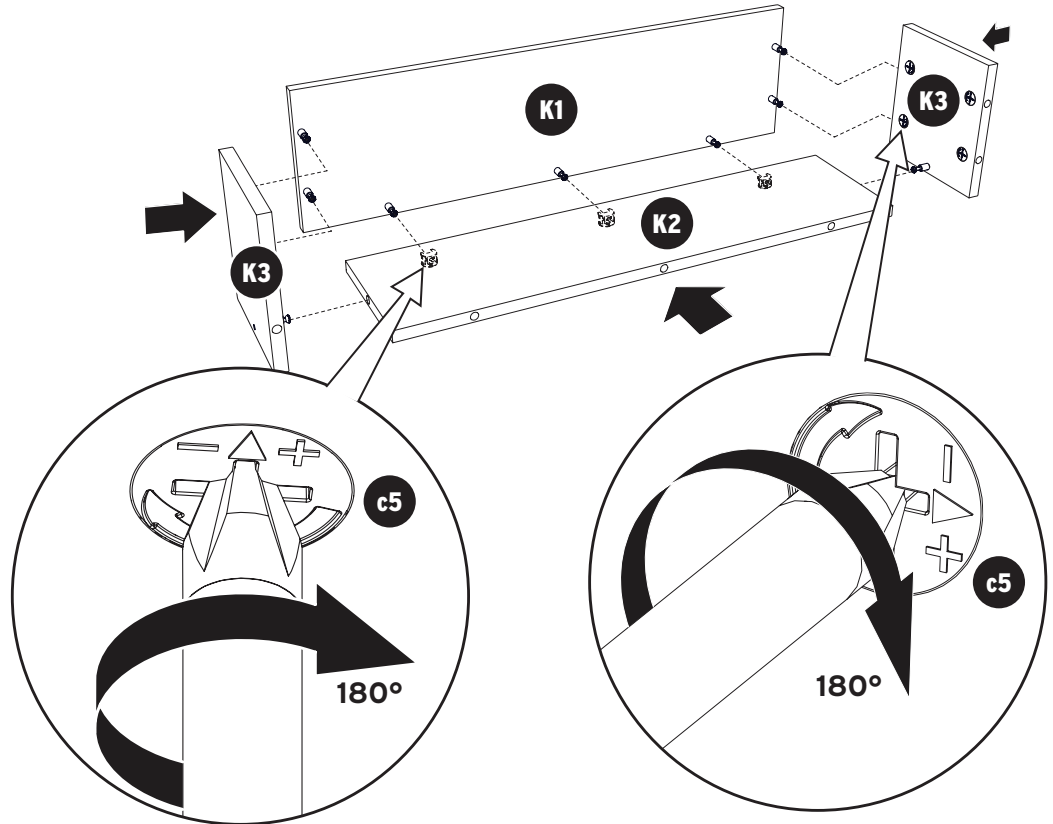

Step 16. Panel V2 assembly.

1. Insert cam bolts **c1** on panel **V2a** into cams on panels **V2b** and tighten in a clockwise direction as illustrated below.
 2. Insert cam bolts **c3** on panel **V2a** into cams on panels **K1** and **K4** and tighten in a clockwise direction as illustrated below.
 3. Fix flush hinges **h2** to panel **V2b** with screws **s2** as illustrated below.
- Apply cam covers **c2** over tightened cams.

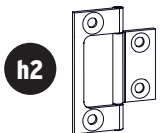

Flush Hinge **x3**



3x14 Screw **x6**



5/8" Cam Cover **x13**

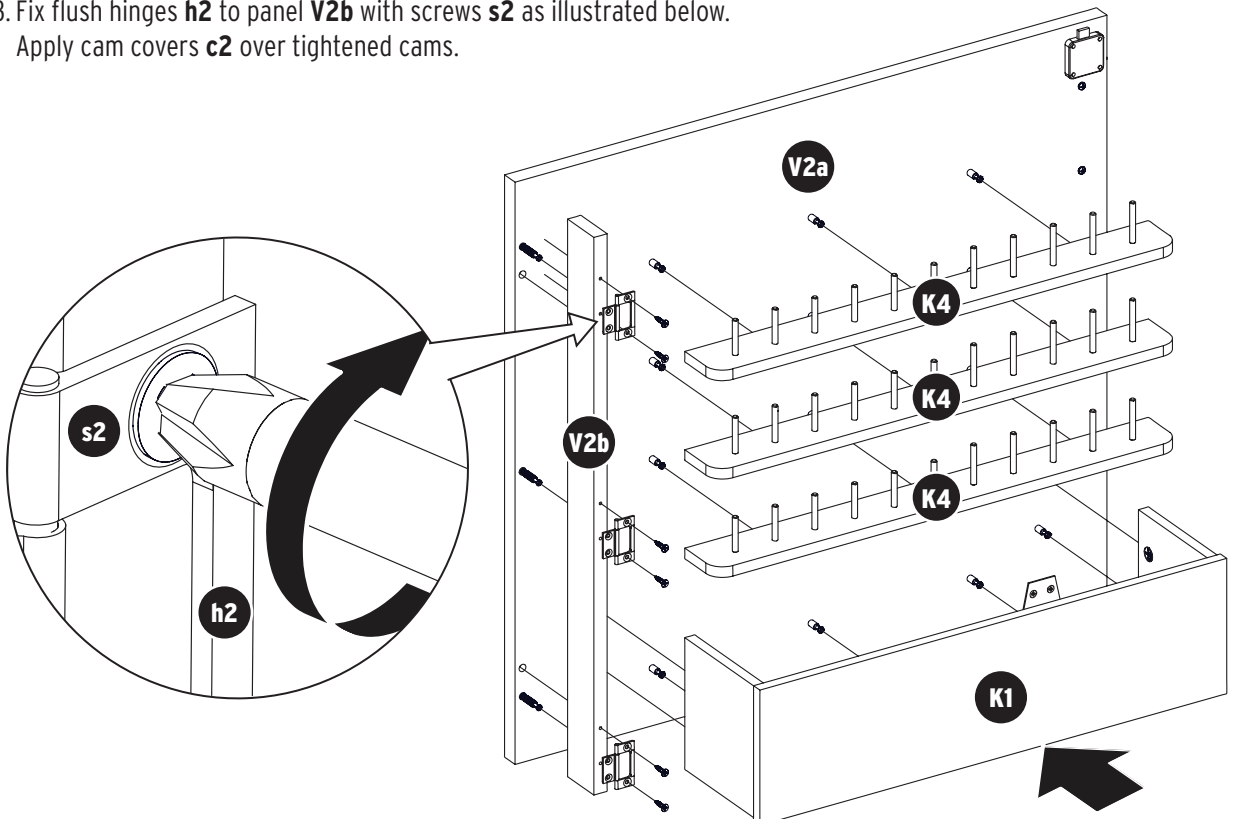

s2 
3x14 Screw **x6**

Step 17. Panel V2 assembly.

Fix Flush hinges **h2** on panel **V2b** to **Z** with screws **s2** as illustrated below. It is helpful to have two people hold the door, but it is not required.

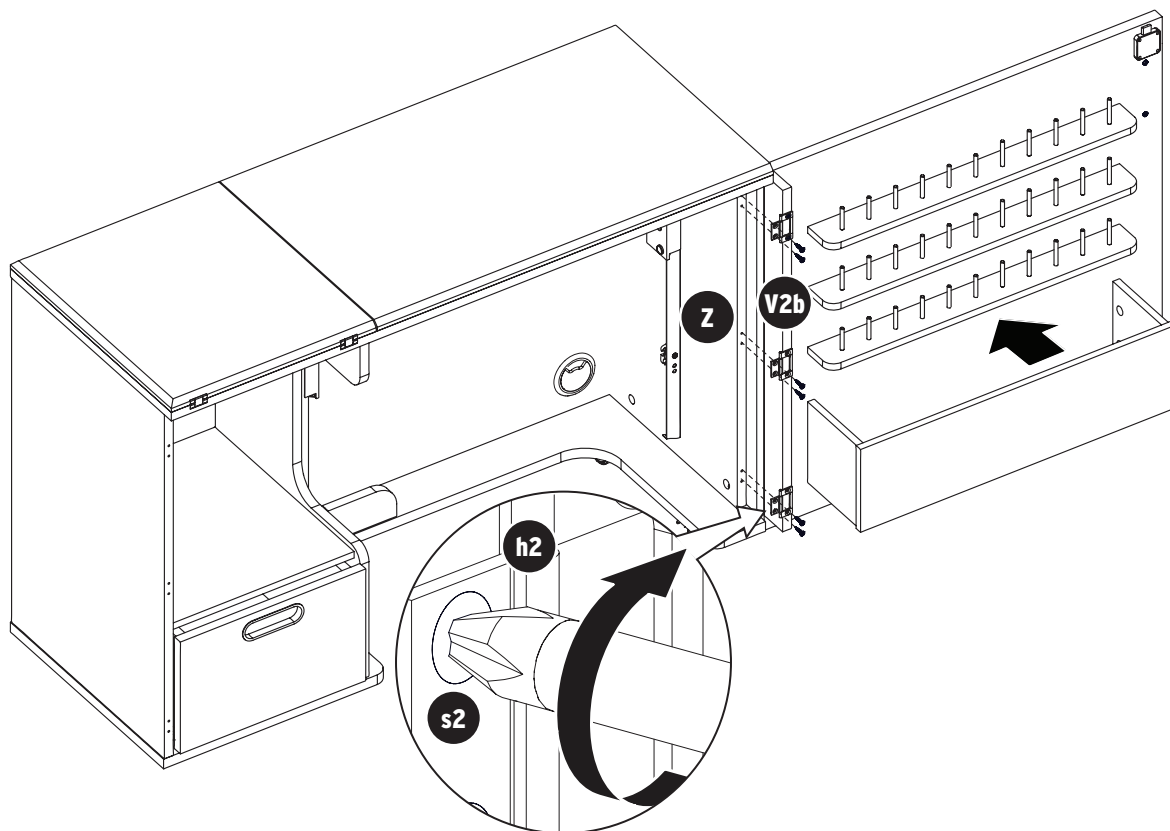

s2 
3x14 Screw **x6**

Step 18. Panel V1 assembly.

1. Fix flush hinges **h2** on panel **V1** to **X** with screws **s2** as illustrated below.
2. Fix Stay Arm **s** with Screws **s1** to panel **V1** as illustrated below.

s1 
3.5x14 Screw **x2**

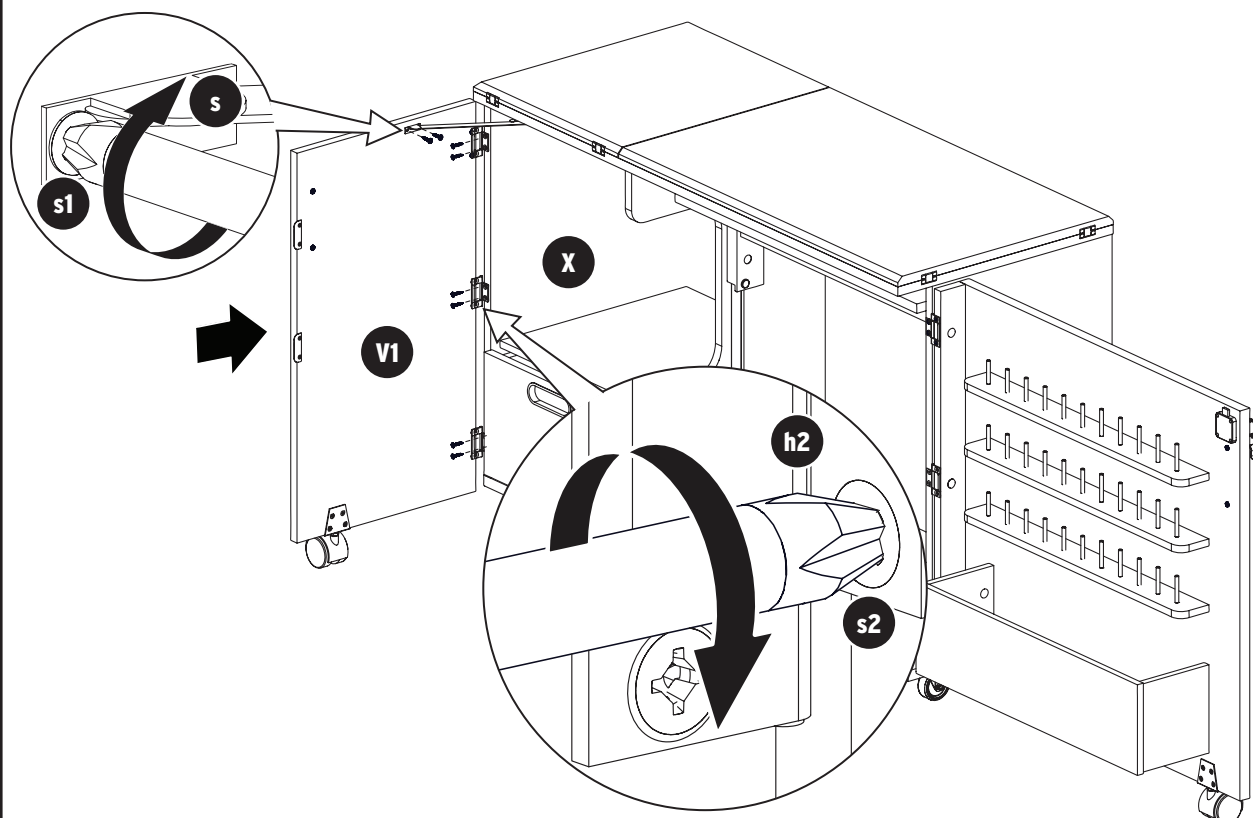

s1 
3.5x14 Screw **x6**

Step 19. Panel 01 assembly.

1. Fix **01** panel butt hinges **h1** on to panel **D** with screws **s1** as illustrated below.

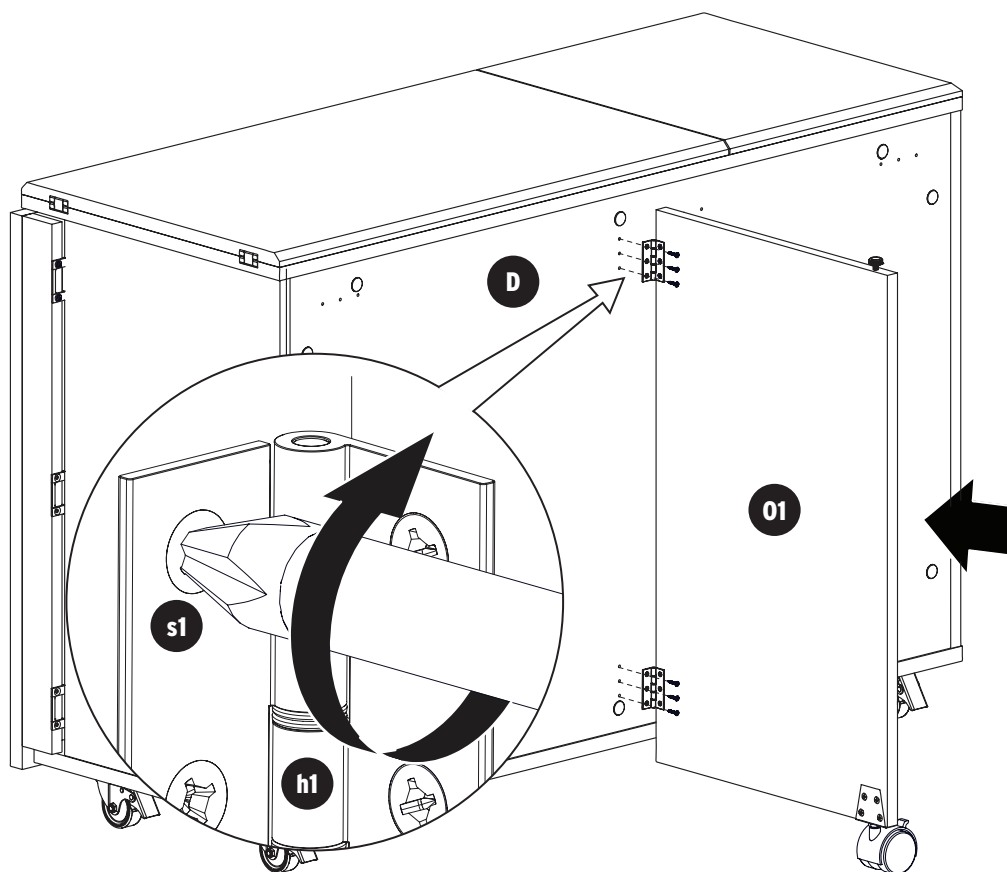

s1 
3.5x14 Screw **x9**

Step 20. Panel A1 assembly.

1. Have a second person hold the **A1** Quilt panel balanced on the gate leg panel **01**.
2. Using screws **s1** attach the flap hinges **h3** to panels **D** and **A1** from underneath panel **A1**.

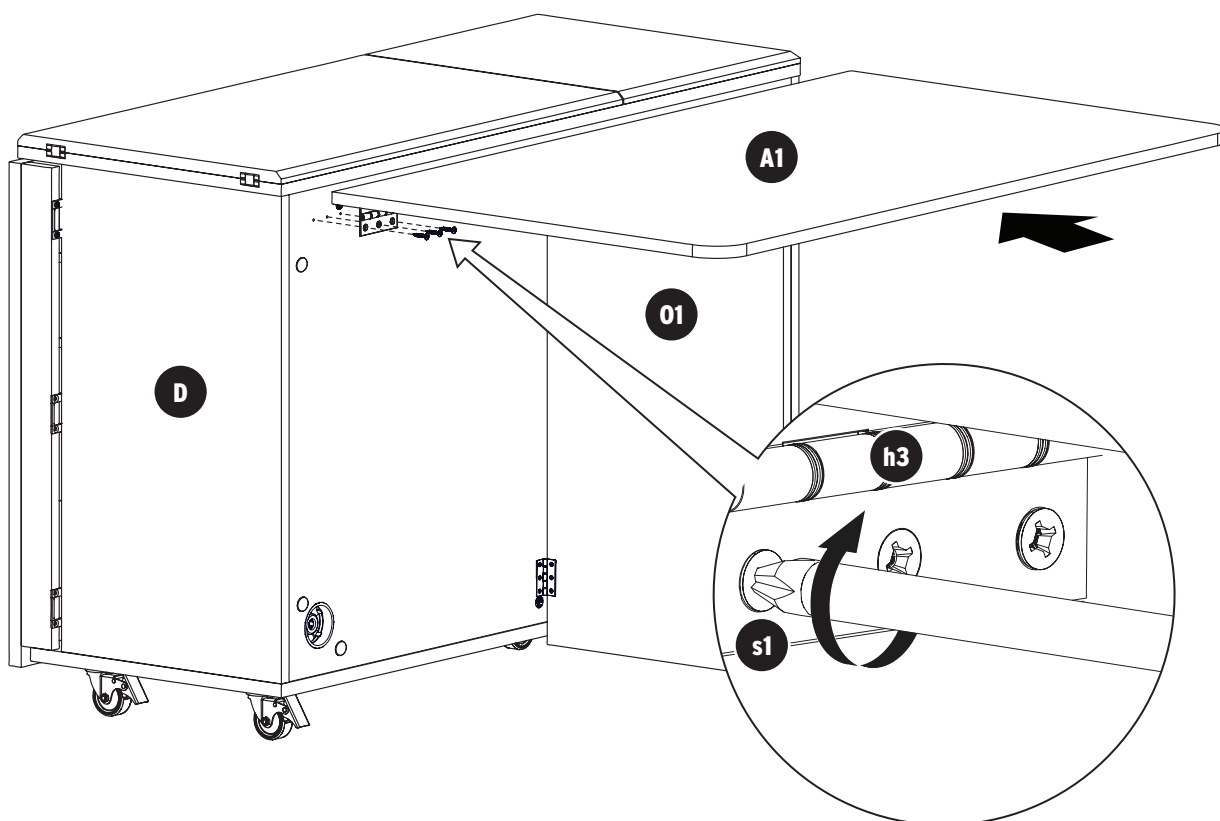

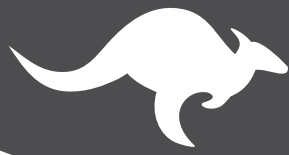

KANGAROO™
sewing furniture

LIMITED LIFETIME WARRANTY

Kangaroo™ Sewing Furniture Limited Lifetime Warranty

WHAT THIS WARRANTY COVERS: Arrow Companies, LLC (Arrow) provides limited warranty coverage to the original purchaser of this product against defects in materials or workmanship of Arrow furniture components for a period of ten years from the date of purchase. As used in this Warranty, "defect" means imperfections in components which substantially impair the utility of the product. This Warranty gives you specific legal rights, and you may also have other rights which vary from state to state.

HOW TO GET SERVICE: Simply contact Arrow at 1-800-533-7347 or CS@ArrowCabinets.com. When you request warranty service, you must also present proof of purchase documentation, which includes the date of purchase (detailed receipt), and photos of the product. Arrow will replace any defective part (at its sole option), excluding labor. Replacement parts will be warranted for only the remaining period of the original Warranty.

Replacement parts will be shipped freight prepaid on any initial warranty claim during first year of Warranty only. Warranty applies only to defects confirmed by Arrow Companies, LLC and will be replaced or repaired at Arrow's option. In the event parts are no longer available for a warranty claim, customer may receive brand new cabinet at a price equal to 60% off the MSRP of a current comparable model.

WHAT'S NOT COVERED: There is no warranty coverage for defects or conditions that result from the failure to follow product assembly instructions, information or warnings, misuse or abuse, intentional damage, fire, flood, alteration or modification of the product, or use of the product in a manner inconsistent with its intended use, nor any condition resulting from incorrect or inadequate maintenance, cleaning, or care, or neglect, cuts or scratches. Caster damage as a result of moving furniture fully loaded or with locked casters. Damage resulting from electrical surge or lightning. Use in commercial or education environments. Kangaroo Sewing Furniture is designed for residential use only.

ARROW SHALL HAVE NO LIABILITY for ANY INCIDENTAL OR CONSEQUENTIAL DAMAGES OF ANY KIND and all such damages are EXCLUDED FROM THIS WARRANTY, such as loss of use, disassembly, transportation, labor or damage to property on or near the product. Some states do not allow the exclusion or limitation of incidental or consequential damages, so the above limitation or exclusion may not apply to you. The Warranty cannot be transferred to subsequent owners or users of the product, and it shall be immediately void in the event the product is resold, transferred, leased or rented to any third party or person other than the original purchaser.

ADDITIONAL LIMITATIONS:

THERE ARE NO OTHER WARRANTIES APPLICABLE TO THIS PRODUCT. Under the laws of certain states, there may be no implied warranties from Arrow and all implied warranties, INCLUDING ANY IMPLIED WARRANTY OF MERCHANTABILITY OR FITNESS FOR A PARTICULAR PURPOSE are disclaimed where allowed by law. TO THE EXTENT ANY IMPLIED WARRANTIES ARE APPLICABLE, ANY IMPLIED WARRANTIES, INCLUDING ANY IMPLIED WARRANTY OF MERCHANTABILITY OR FITNESS FOR A PARTICULAR PURPOSE, ARE LIMITED IN DURATION TO THE DURATION OF THIS EXPRESS WARRANTY or the minimum period allowed by law, whichever is shorter. Some states do not allow limitations on how long an implied Warranty lasts, so the above limitation may not apply to you. This limited warranty gives you specific legal rights. This limited warranty does not, in any way, affect the rights given to you by law.

REGISTER YOUR PRODUCT: Original purchaser should register the purchase online at www.ArrowCabinets.com/warranty.

SEW IN COMFORT. SEW LONGER.™

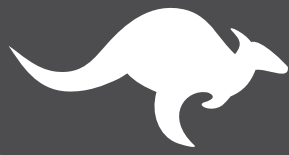

KANGAROO™

sewing furniture

Accessories to Complete Your Sewing Experience

Custom Insert

Enhance your sewing experience with a custom-made insert for your Arrow or Kangaroo cabinet. Inserts are designed to reduce the gap between the machine and cabinet opening. This provides an ergonomic work surface for the free arm of the sewing machine, allowing for straighter stitches, less fatigue and an overall better experience using your machine and cabinet.

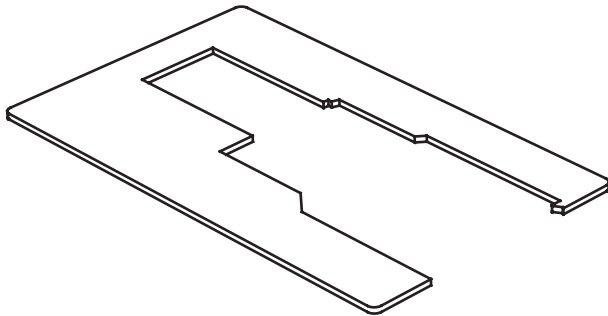

Insert

Arrow Sewing Chairs

Our adjustable height sewing chair is a perfect accessory for any craft and sewing room. The chair's height is adjustable with easy to use controls and the cushions provide perfect lumbar support and comfort for those long sewing hours. Chair features five casters on a star base for greater movement at your sewing cabinet or crafting surface. Lift the seat cushion to reveal a hidden storage compartment for your small notions or patterns.

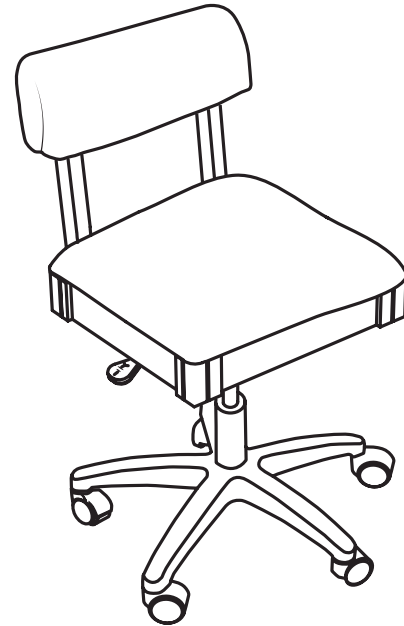

Hydraulic Sewing Chair

P.O. Box 307 Delavan, WI 53115
1-800-533-7347 Ext. 1
CS@ArrowCabinets.com
www.ArrowCabinets.com

07-20

SEW IN COMFORT. SEW LONGER.™