



# Strawberry Delight

*By Alex Anderson; quilted by Angela Walters*

*Quilt size 59 $\frac{1}{2}$ " x 59 $\frac{1}{2}$ "; Block size 6" x 6"*

# Strawberry Delight instructions

**Quilt size** 59½" x 59½"  
**Block size** 6" x 6"

## Fabric & Cutting Requirements

Fabric	Yards	Cut
White solid	4 yds.	41 A, 272 B, 48 C, 36 D, 20 E, 6 F, 2 G 7 binding strips 2¼" x WOF
Pink and red prints	1 yd.	272 B, 41 scoops
Gray prints	¾ yd.	68 C, 41 cones
Backing	4 yds.	2 panels 37" x 72"
Batting		72" x 72"

Yardage is based on fabric 40" wide.

Also needed: 2 yds. 20" Quilters Select Appli-Web Plus or equivalent, 2 yds. Quilters Select TearAway, Teflon pressing sheet or parchment paper; thread to match the applique fabrics; Quilters Select Soft Machine Batting

## Patches

- A = 7½" square
- B = 1½" square
- C = 2½" square
- D = 2½" x 4½" rectangle
- E = 2½" x 6½" rectangle
- F = 10" square
- G = 5¼" square

## Getting started

Presoak red, pink, and gray fabrics in hot water until all excess dye is released. Press all fabrics. Starch lightly if desired.

Print the Strawberry Delight applique pattern.

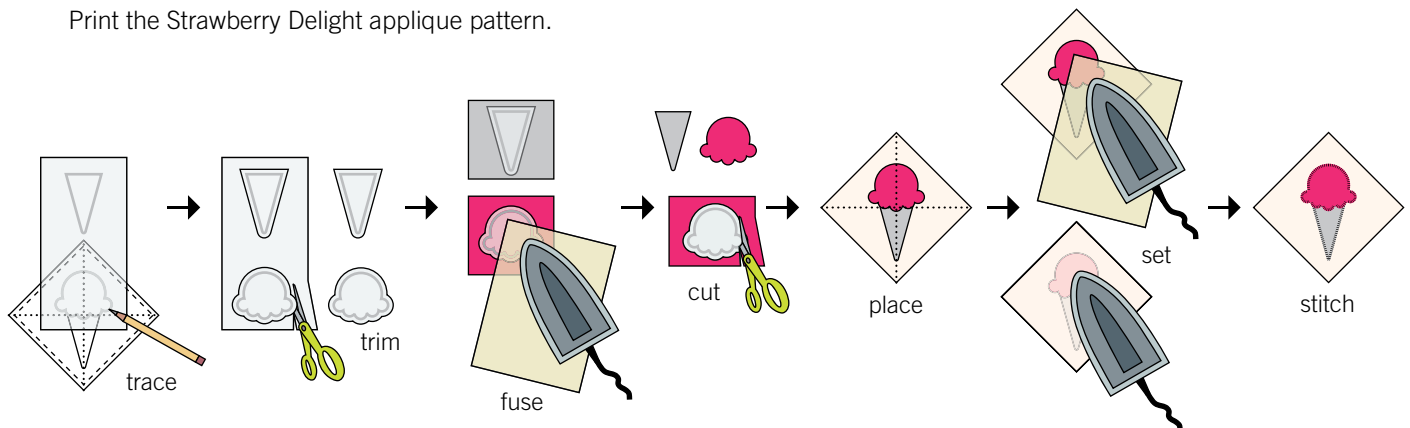

Fig. 1

## Cutting the white solid

Cut the binding strips first and set them aside. Cut the patches listed in the Fabric & Cutting Requirements. The A patches are oversize and will be trimmed after the applique is completed. Cut the F patches diagonally twice to make 4 triangles. Cut the G patches diagonally once to make 2 triangles.

## Cutting the prints

The Fabric & Cutting Requirements list the total number of patches needed to make the quilt. For a scrappy quilt like this, Alex waits to cut these patches as she makes the blocks.

## Applique the ice cream cone blocks

Refer to the Fig. 1 and the manufacturer's directions. Trace a scoop motif and a cone motif onto the paper side of the Appli-Web Plus, leaving a little room between the motifs. Cut the traced shapes out roughly and fuse them to the back side of your chosen fabrics. Once fused, cut the patches on the drawn lines.

Fold a solid white A in half diagonally twice and finger press the folds to locate the center.

Using the folds as a guide, position the prepared patches on the A. Fuse the patches in place.

Cut a piece of Select TearAway slightly larger than the area to be appliqued. Place the shiny side of the TearAway on the back side of the A. Cover the stabilizer with the pressing sheet or parchment and fuse in place.

Using matching thread and a small blanket or zigzag stitch, stitch around the edges of the applique patches. Once stitching is complete, gently tear away the excess stabilizer.

Place the appliqued A face down on a padded surface and press. Measuring from the center, trim the A to 6½" square. Make 41.

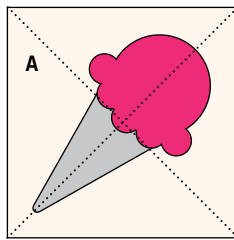

**Strawberry Delight Applique Block**  
Make 41

### Make the 4-patch units

Referring to the 4-patch piecing diagrams, join 2 solid white B's and 2 red/pink B's to make 128 Unit 1 and 8 Unit 2.



**4-Patch Unit 1**  
Make 128

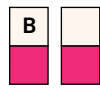

**4-Patch Unit 2**  
Make 8

### Make the pieced blocks

Referring to the Border Block 1 piecing diagram, join 2 4-patch units and 1 gray print C with a solid white C, D, and E as shown. Make 16.

Similarly, join 4 4-patch units and 2 gray print C's with a solid white C and D as shown in the Border Block 2 piecing diagram. Make 20.

Refer to Corner Block 1 and Corner Block 2 piecing diagrams to make 4 blocks each.

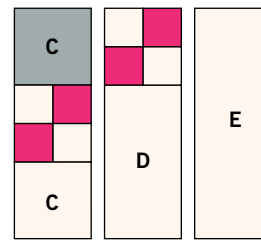

**Border Block 1**  
Make 16

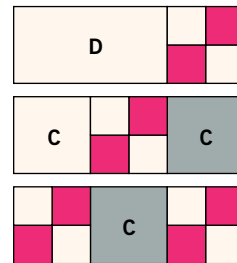

**Border Block 2**  
Make 20

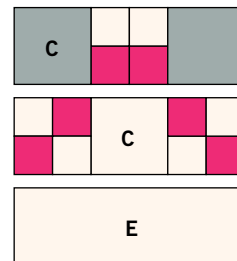

**Corner Block 1**  
Make 4

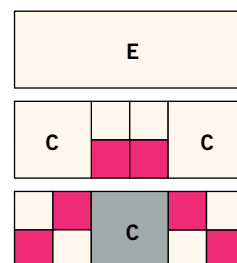

**Corner Block 2**  
Make 4

## Assembling the quilt

Refer to the Quilt Assembly diagram. On a design wall or large flat surface, arrange the blocks in diagonal rows. Pay careful attention to the orientation of the border blocks. When you are satisfied with the arrangement, join the blocks into rows. Add F triangles to the ends of the rows. The triangles are slightly oversize.

Matching seams, join the rows. Sew G triangles to the corners of the quilt.

Press the quilt top and trim it to measure 60" square, raw edge to raw edge.

## Finishing the quilt

Refer to the manufacturer's instructions for helpful tips for fusing Select Soft Machine Batting.

Set your iron for a rayon/polyester setting. Lay Select Soft Machine Batting on the ironing board or work surface. Mist the batting lightly and evenly with water. Layer the backing fabric on the batting. Press evenly with the iron, one section at a time. Let cool to room temperature. After the backing is adhered, flip the batting over and repeat to fuse the quilt top.

Refer to the quilt photo to see Angela's quilting motifs. Quilt as Angela did or as desired.

Join the binding strips end to end with diagonal seams. Fold in half lengthwise, wrong sides together, and press. Bind the quilt to finish.

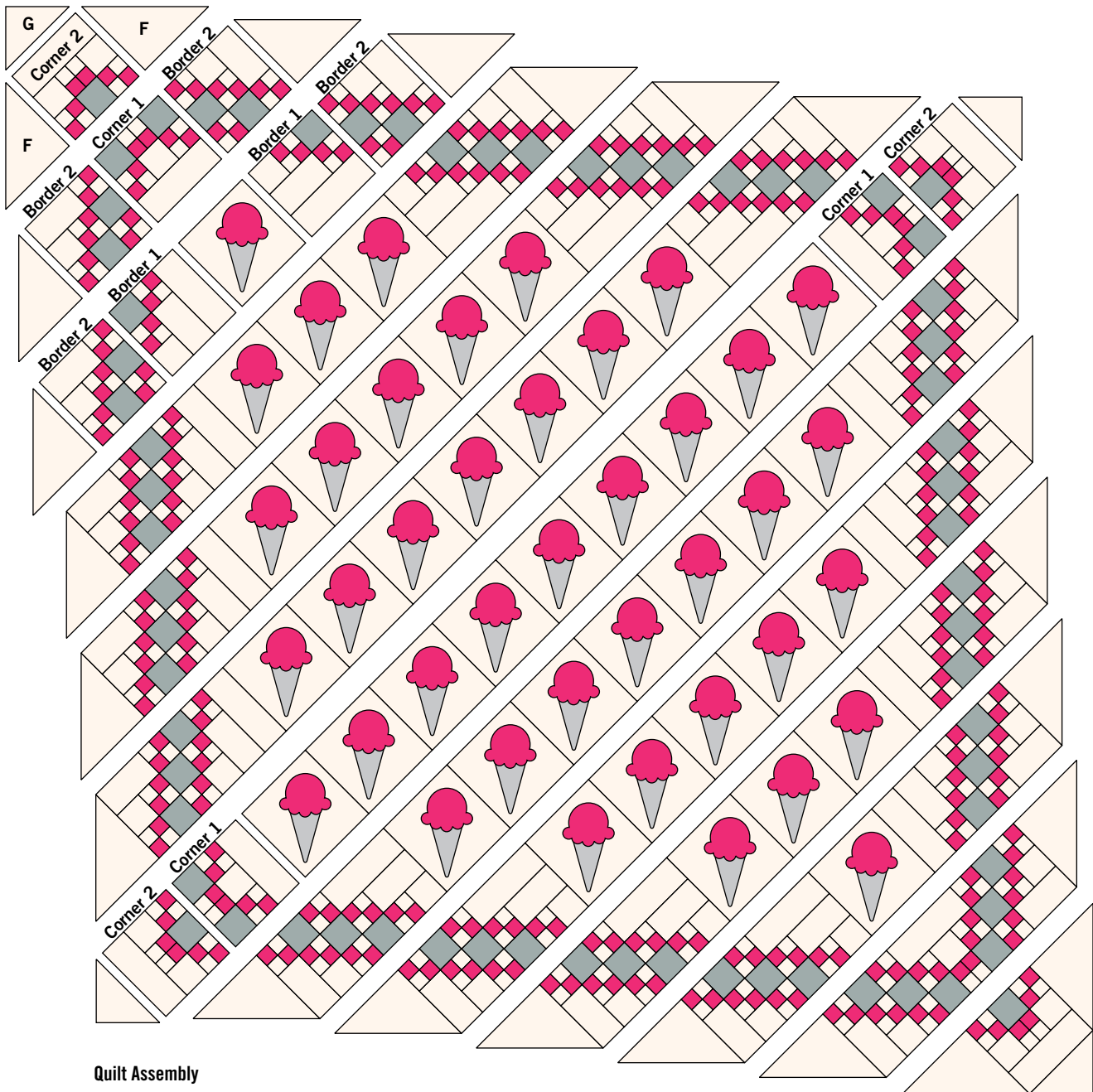

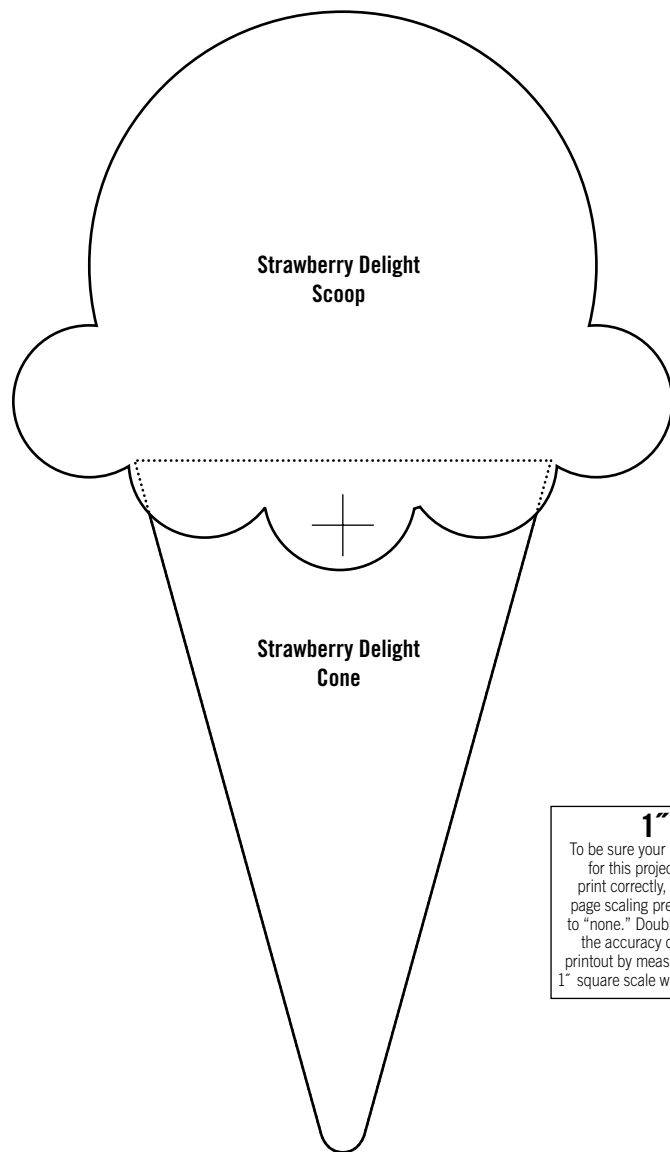

**1"**  
To be sure your patterns for this project will print correctly, set the page scaling preference to "none." Double-check the accuracy of your printout by measuring the 1" square scale with a ruler.