

Tin Lizzie18

Your Affordable Longarm Quilter

Micro Handles

(Micro Handles face plate designed for machines manufactured August 2007 to present)

Attachment instructions for your new Micro Handles.

Included with your Micro Handles you should have two screws for attaching the Face plate, the Face plate, two screws for attaching your Micro Handles, and the Micro Handles.

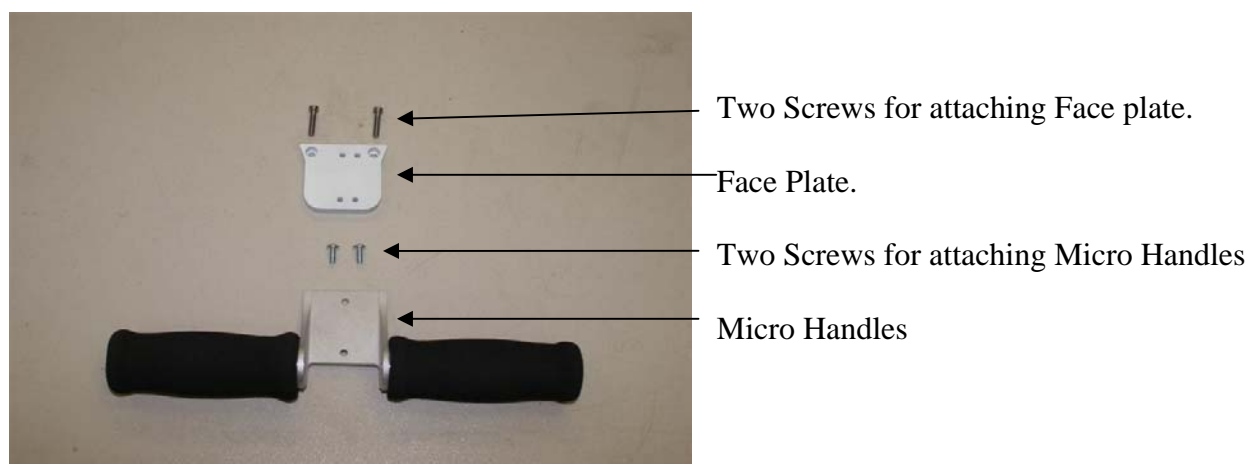

First you will need to remove the two screws from the face plate.

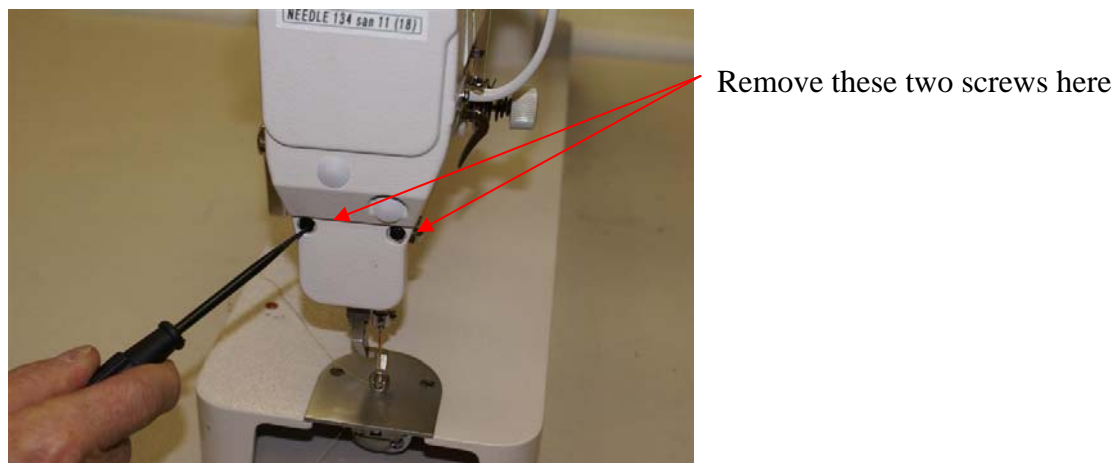

7096 S Redwood Rd
West Jordan Utah
84084

PHONE (801) 255-4130
FAX (801) 255-5554
WEB SITE <http://www.tinlizzie18.com>

Now attach the face plate with the new face plate screws.



Make sure this new Face plate is lined up with the other face plate and tighten. This new face plate does not need to be removed when you remove the Micro Handles.

Next we are going to attach the Micro Handle. You will notice that there are two sets of holes for the Micro Handles to be attached. Use the two screws provided to attach the Micro Handles.

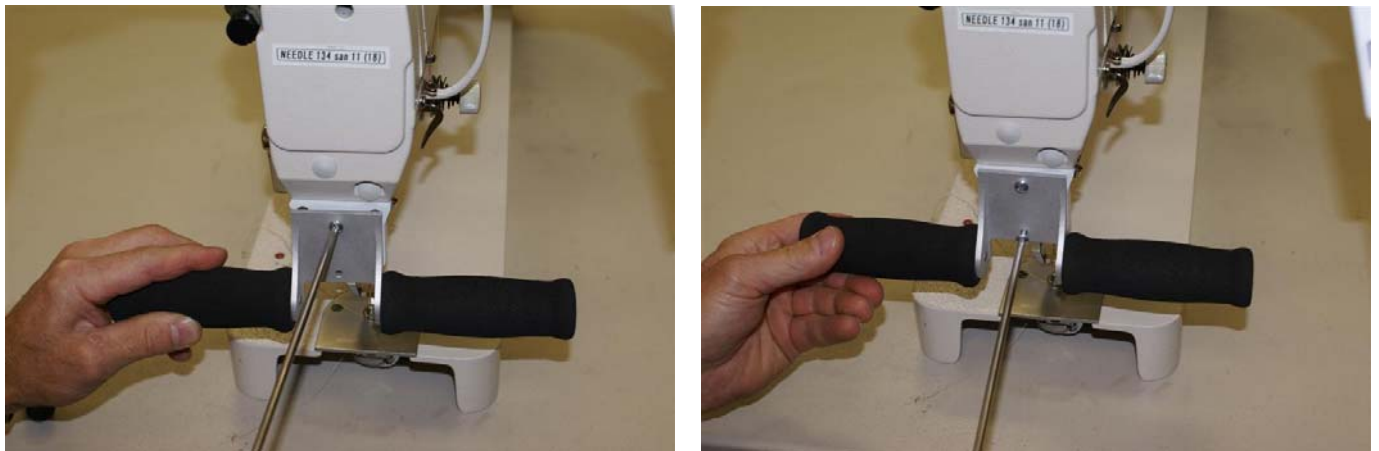

Handles in position 1



Handles in position 2