

# King Quilter II Elite 16 5-foot Frame

## Assembly Instructions

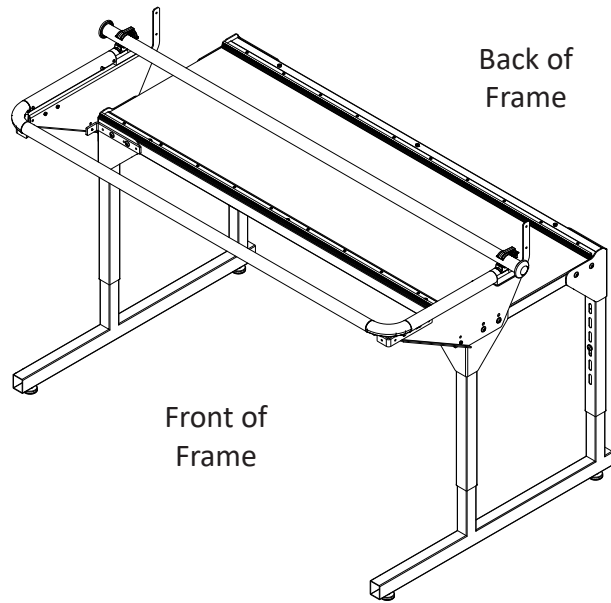

## Table of Contents

Frame Parts and Hardware	2
Table and Leg Assembly	4
Side Arm and Pole Assembly	7
Track Alignment	13
Leveling and Setting Height	14

## Introduction

These instructions cover the King Quilter II Elite 16 5-foot Frame set up for the King Quilter II Elite 16 machine. The frame enables you to use the quilting machine within a smaller footprint than a standard frame, yet you can do quilts of any size.

## What's Included

Your King Quilter II Elite 16 5-foot Frame is delivered in two separate boxes. After opening, check immediately to see that you have received the items listed in the Parts and Hardware list found on pages 2 and 3.

### Box 1:

Includes side arms and supports, upper leg supports, King Quilter II Elite 16 5-foot Frame assembly instructions, and all other parts and hardware.

### Box 2:

- 1 – Table top with tracks
- 2 – Lower legs
- 1 – Front pole (56")
- 1 – Rear pole (68")

# Frame Parts and Hardware

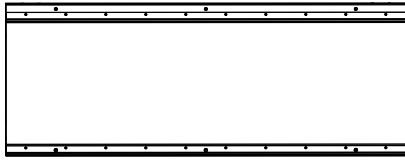

- 1 - Table Section with Plastic Top (QF05300-300)
  - 1 - Track Assembly 4 Wheel Front (QF05300-11)
  - 1 - Track Assembly 4 Wheel Rear (QF05300-12)
  - 6 - Screw M6x12 w/17mm SWH (QF09318-303)
- (Box 2)**

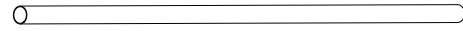

- 1 – Front pole (56")
- #QF10005 (Box 2)**

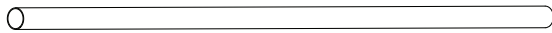

- 1 – Rear pole (68")
- #QF10009 (Box 2)**



- 2 – Rear pole end caps
- #QF10011 (Box 1)**

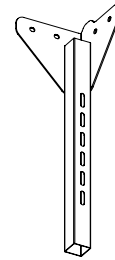

- 2 – Upper leg B
- #QF05300-403 \* (Box 1)**

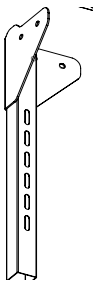

- 2 – Upper leg A
- #QF05300-402 \* (Box 1)**

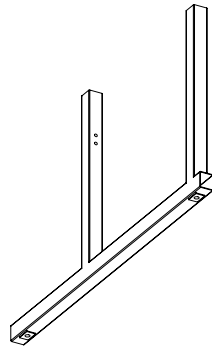

- 2 – Lower legs
- #QF05300-401 (Box 2)**

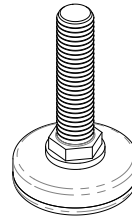

- 4 – Leveling foot
- #QF09318-108 (Box 1)**



- 4 – Nylon washers
- #QF05300-157 (Box 1)**



- 16 – M6 x 10mm socket cap screws #QF10006
- (Box 1) Note:** 1 each in 2 Assy Pole Ends already

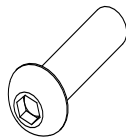

- 20 – M8 x 20mm socket button head cap screws (SBHCS)
- #QM10959 (Box 1)**

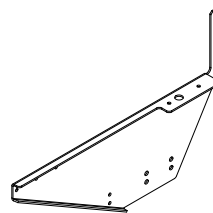

- 1 – Right side arm
- #QF10007 (Box 1)**

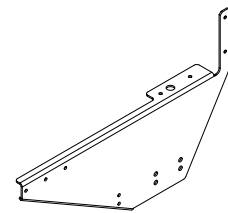

- 1 – Left side arm
- #QF10008 (Box 1)**

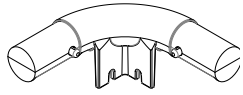

2 – Front pole corner connectors  
#QF10003 (Box 1)

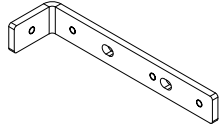

4 – L-brackets  
#QF10010 (Box 1)

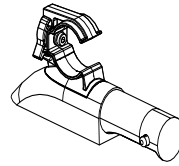

1 – Assy Pole End Right  
#QF10042 (Box 1)

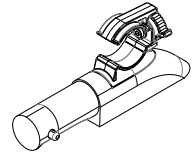

1 – Assy Pole End Left  
#QF10043 (Box 1)

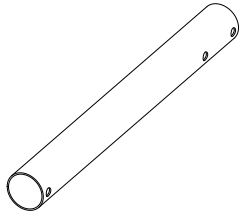

2 – Side arm pole  
#QF10004 (Box 1)



1 – 17/13 mm wrench  
(for leveling feet)  
#QF09318-114 (Box 1)

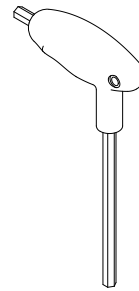

1 – 5 mm hex tool  
#QF09318-113 (Box 1)

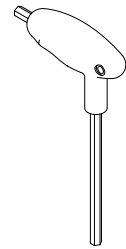

1 – 4 mm hex tool  
#QF09318-112 (Box 1)



1- 2.5mm Hex Driver  
#QF09318-116 (Box 1)

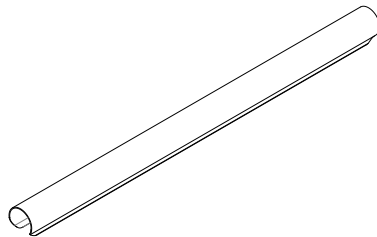

1- HQ Super Quilt Clamp  
#QF10018 (Box 1)



6 – Hold-Tight Clamps  
3 small #HG10000  
3 large #QF10014  
(Box 1)

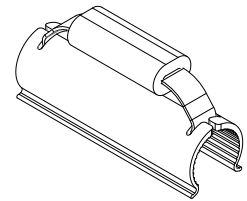

6 – Easy-Grasp  
Quilt Clamps  
#QF10013 (Box 1)

Notes:

1. The QF05300-403, Upper Leg B is used on the Left Front and the Right Rear Corners.
2. The QF05300-402, Upper Leg A is used on the Right Front and the Left Rear Corners.

# Table and Leg Assembly

## Parts Needed

- 1 - Table section
- 2 - Upper leg A
- 2 - Upper leg B
- 2 - Lower leg
- 4 - Leveling feet
- 20 - M8 x 20 mm socket button head cap screws
- 4 - Nylon washers
- 2 - L-brackets

## Tools Required

- 5 mm hex tool (provided)
- 17/13 mm wrench (provided)
- Spirit level (optional, not provided)

1. Place the table section face down onto a protective surface.

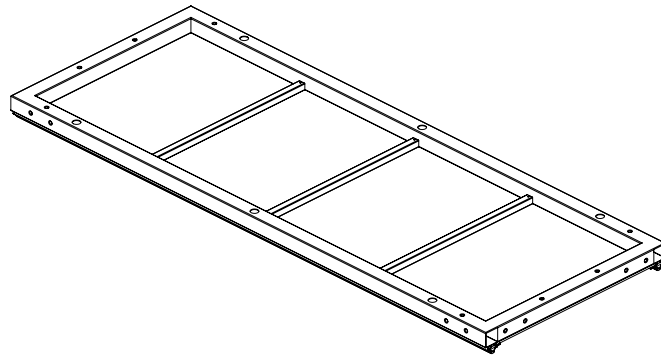

2. Attach the upper legs: Position the upper legs A and B so the height adjustment holes face each other across the short end of the table.

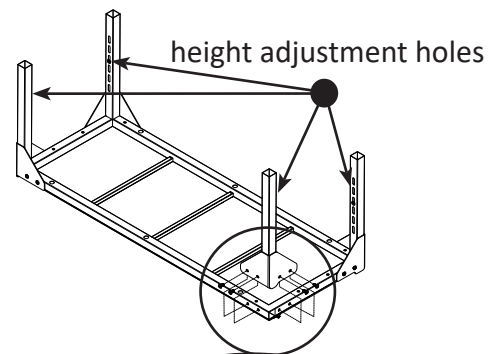

3. Attach each upper leg to the table with four (4) M8 x 20 mm socket button head cap screws (SBHCS) through the upper corner leg brackets into the holes on the sides of the table.

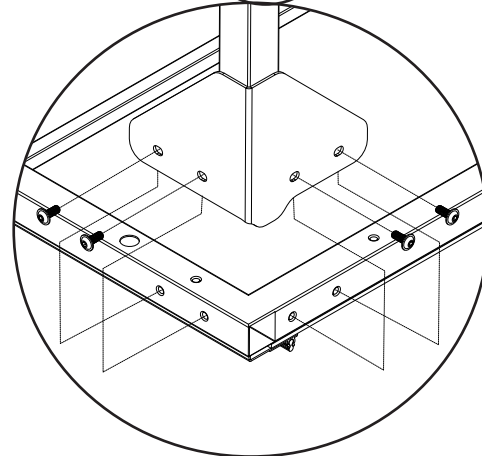

4. Tighten with the 5 mm hex tool. (Do not fully tighten the screws at this time as you will remove these screws to attach L-brackets later in the installation process.)

5. Insert the lower legs: Slide one lower leg onto the two upper corner legs on each end of the frame. The extended end of the lower leg faces what will be the front of the frame. Repeat for the opposite end of the frame, orienting the extended end of the lower leg the same way as the first leg.

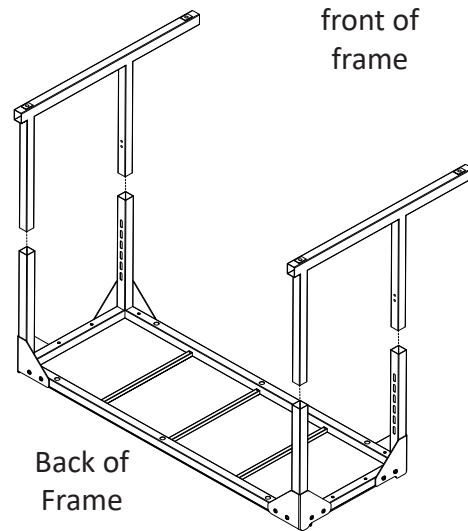

6. Insert the leveling feet: Thread a leveling foot into each end of the leg assemblies.

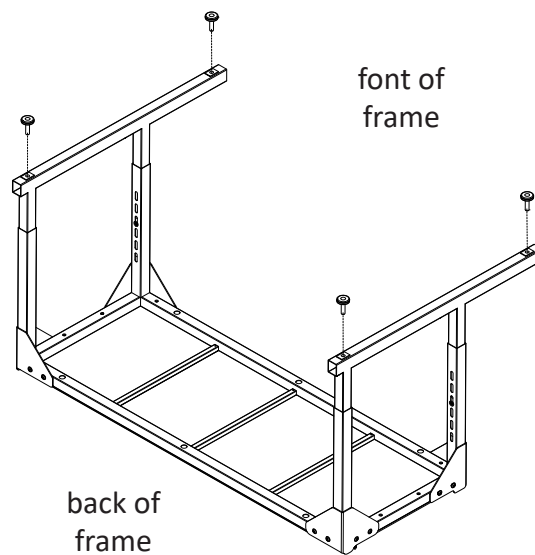

7. Use the 17/13 mm wrench to tighten the leveling foot, leaving about 1/2 inch of threads exposed to make it easier to level the frame later.

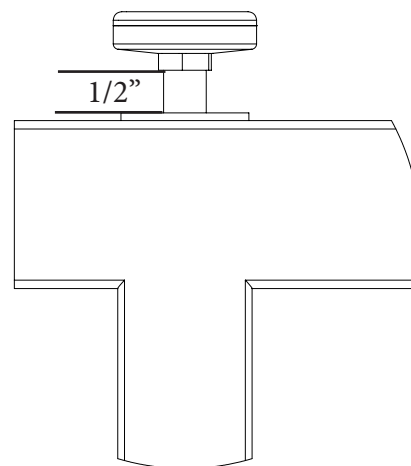

- Set the frame height: Decide on the preferred height of the frame. Use the image at the right. Identify which height adjustment holes to use for securing the lower legs.

Place an M8 x 20mm SBHCS with a nylon washer into the same height setting on each of the corner legs. (The nylon washer protects the paint in case you change the height setting later.) Fully tighten the screw on each leg with the 5 mm hex tool.

**NOTE:** Adjust the frame height so that when standing at the front of the machine with your hands on the front handle bars, your elbows are bent at a 90-degree angle.

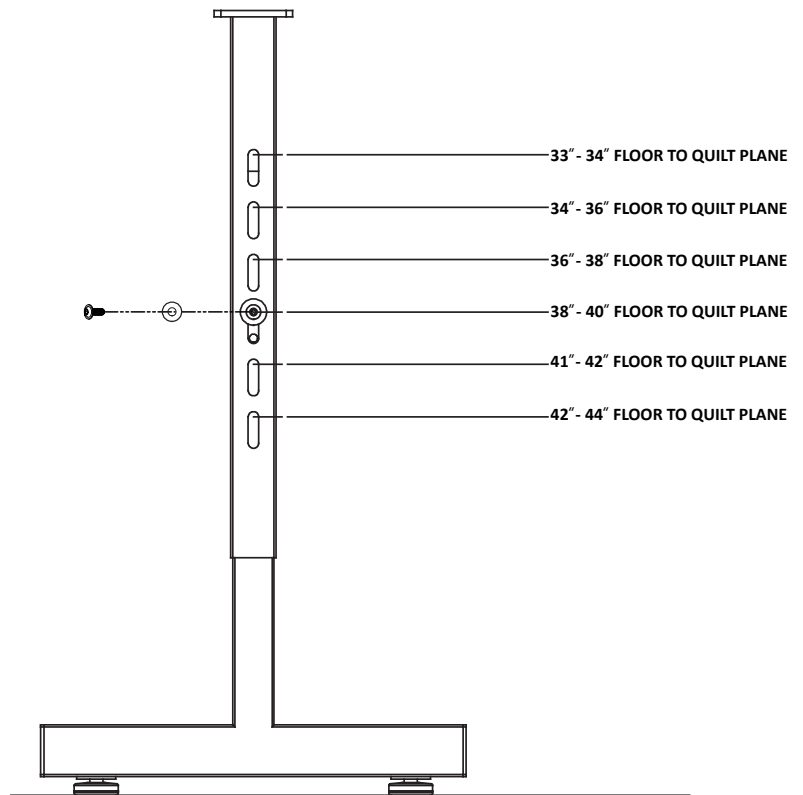

- Stand the frame upright: With the help of a second person, lift the frame into an upright position.

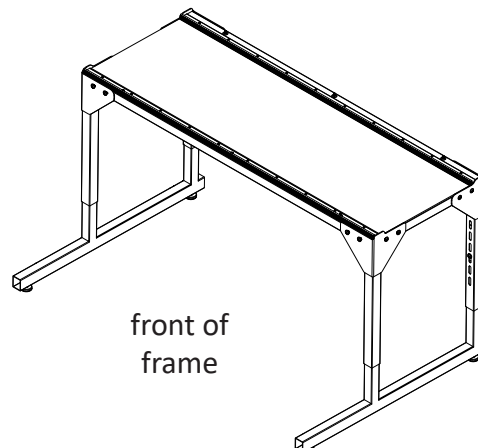

- Attach short L-brackets QF10010: With the 5 mm hex tool, loosen and then remove the screws from the front of an upper leg. (See the detail in the next figure.)

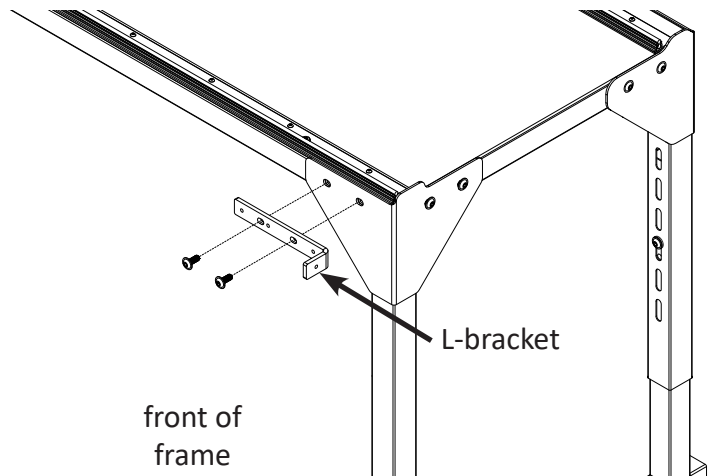

- Align the holes in one of the L-brackets over the leg holes on the long side of the table, replace the screws, and tighten. Repeat steps 10 and 11 with the other front upper leg.

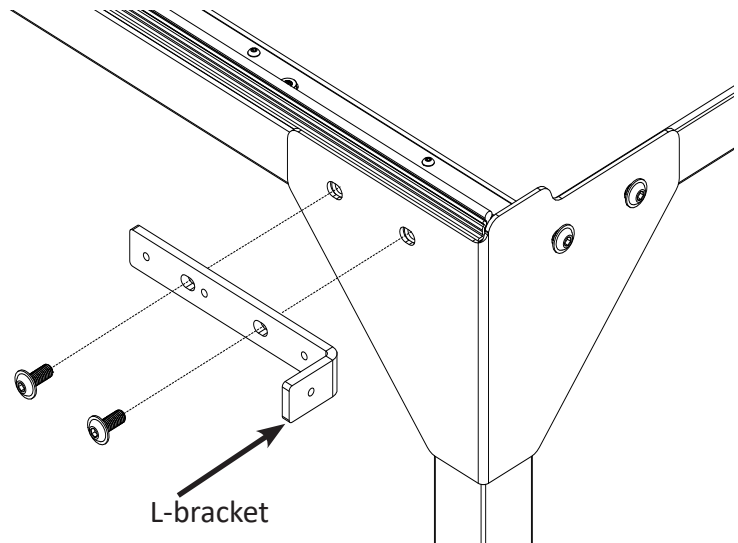

## Side Arm and Pole Assembly

### Parts Needed

- 2 – Side arms
- 14 – M6 x 10mm socket cap screws
- 2 – L-brackets
- 1 – Left pole end assembly
- 1 – Right pole end assembly
- 2 – Side arm poles
- 2 – Front pole corner connectors
- 2 – Rear pole end caps
- 1 – Rear pole
- 1 – Front pole

### Tools Required

- 5 mm hex tool (provided)
- 4 mm hex tool (provided)
- 17/13 mm wrench (provided)

- Attach the right and left side arms: Use the 5 mm hex tool to remove the screws from the side of the right upper leg. \*Using the bottom row of holes on the side arm, place a screw in the left large hole in the right side arm and align with the left large hole in the upper leg. Partially tighten the screw for now to secure to the side of the frame. Repeat with the other large hole.

 \*Note: The bottom row of holes are used for the King Quilter II Elite 16 machine.

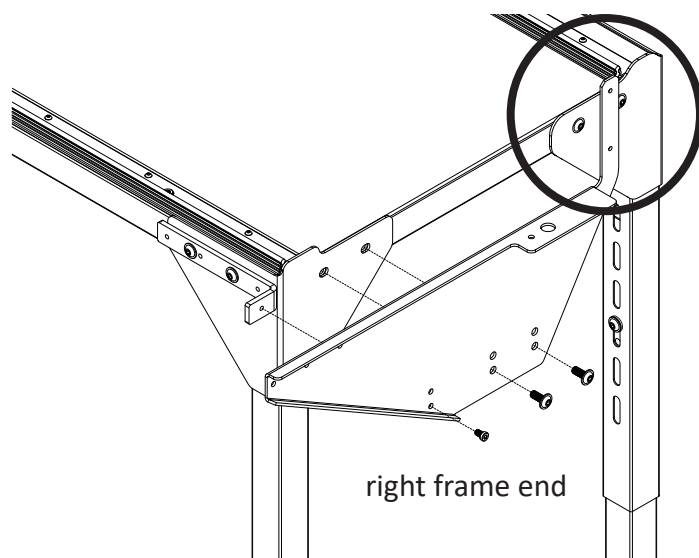

 **NOTE:** Note the orientation of the side arms in the figure above. The vertical metal extension (circled) is positioned toward the back of the frame.

2. Use the 4 mm hex tool to screw one of the M6 x 10mm socket cap screws to secure the side arm to the L-bracket.

3. With both large screws and the small screw in place now tighten fully all three screws.

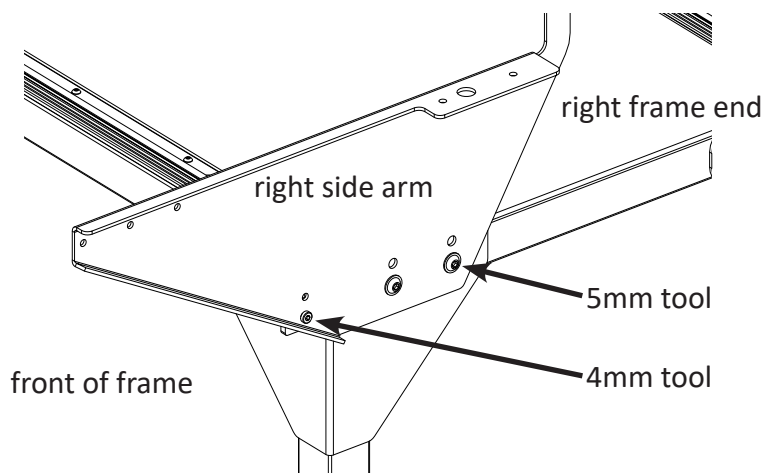

**NOTE:** If the L-bracket isn't flush with the side arm, you will need to loosen the screws that hold it to the front of the table and slide it until it is against the side arm. Then retighten the screws and secure the side arm to the L-bracket as described in step 2.

4. Repeat steps 1, 2 and 3 for the left arm. Check that all screws are fully tightened connecting the side arms to the frame.

5. Attach the left and right side arm pole end assemblies: Use the 4 mm hex tool and two (2) M6 x 10mm socket cap screws to attach the pole end assemblies to each side arm.

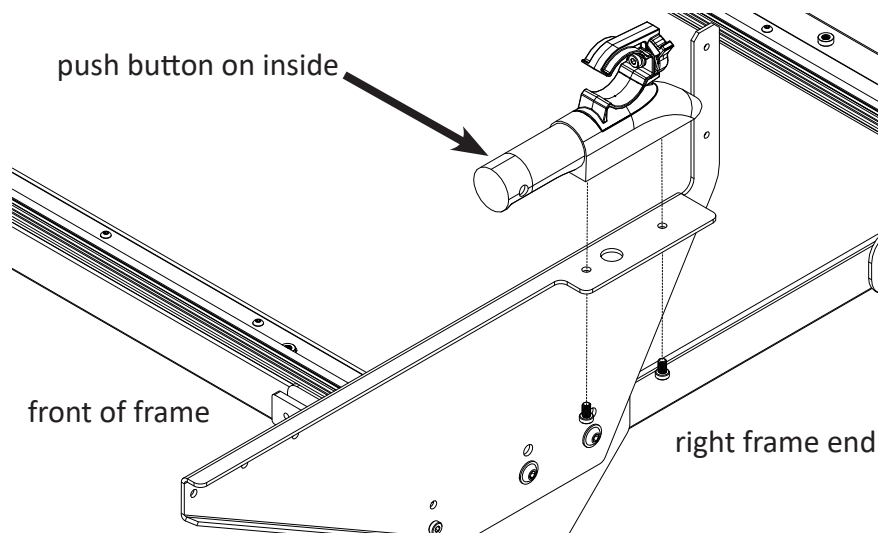

**NOTE:** Make sure you have identified the right and left pole end assemblies. When properly installed, the silver push button on pole end assembly will face the center of the frame.

6. Press in the push button on the pole end assembly and slide the side arm pole onto it.

**For the King Quilter II Elite 16 machine:** make sure the button snaps into the second hole in the pole (see arrow).

Repeat with the other side of the frame.

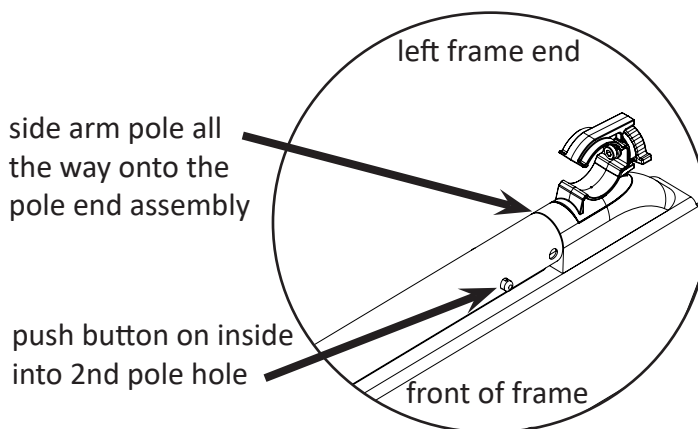

Set up for King Quilter II Elite 16 machine.



7. Assemble the front pole: Identify the front pole corner connectors. Press in the button on one of the front pole corner connectors and insert it into the right side of the front pole until the button snaps in place. Press in the button on the other front pole corner connector and insert it into the left side of the front pole until the button snaps in place.

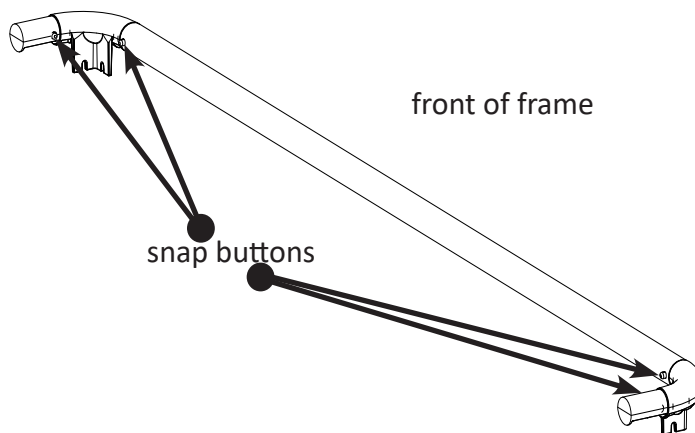
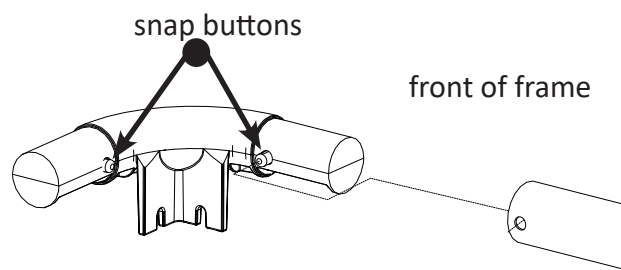

8. Attach the front pole assembly to the frame: Press in the button on the right side of the front pole assembly and insert the pole into the side arm poles until the button snaps in place. Repeat with the left side of the front pole assembly and the left side of the frame

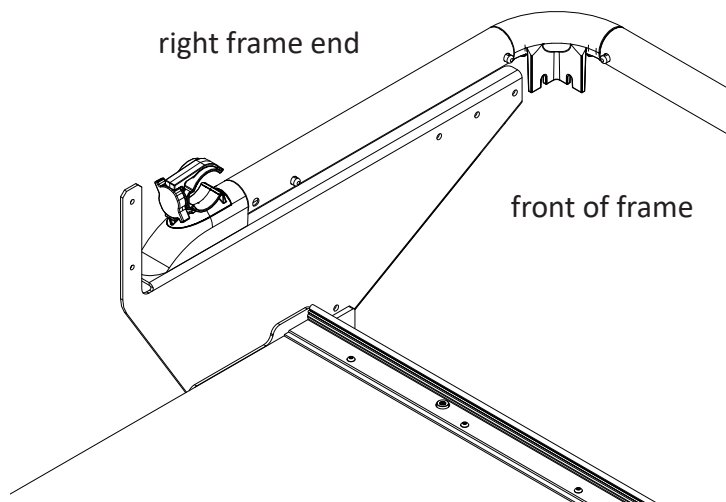

9. Attach two L-brackets (QF10010): Insert two (2) M6 x 10mm socket cap screws into the holes on the inside of the side arm and use the 4 mm hex tool to tighten the screws to secure side arm to the L-bracket. Repeat on the other side of the frame.

**Set up for King Quilter II Elite 16 machine:**

Align the holes in the L-bracket with the side arm holes as shown in the figure at the right (***back two holes on the side arm and back two small threaded holes on L-bracket***).

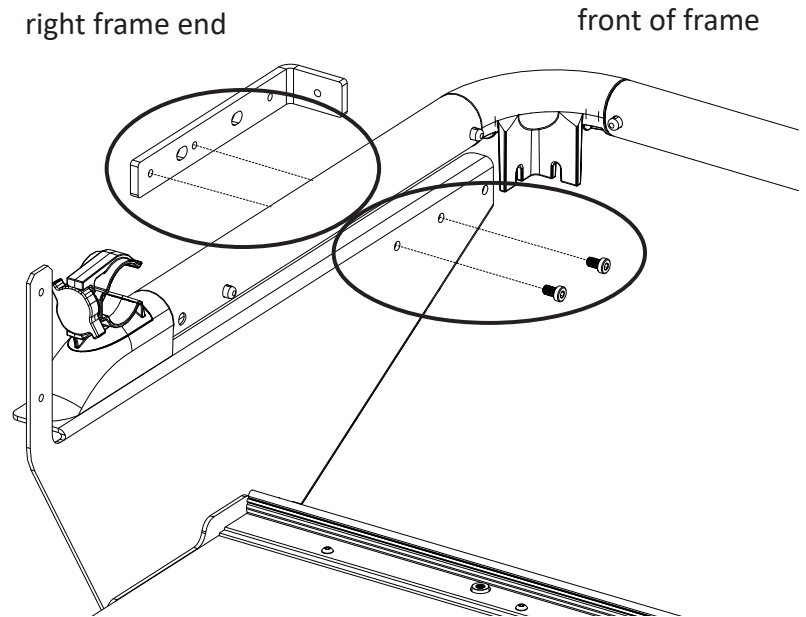

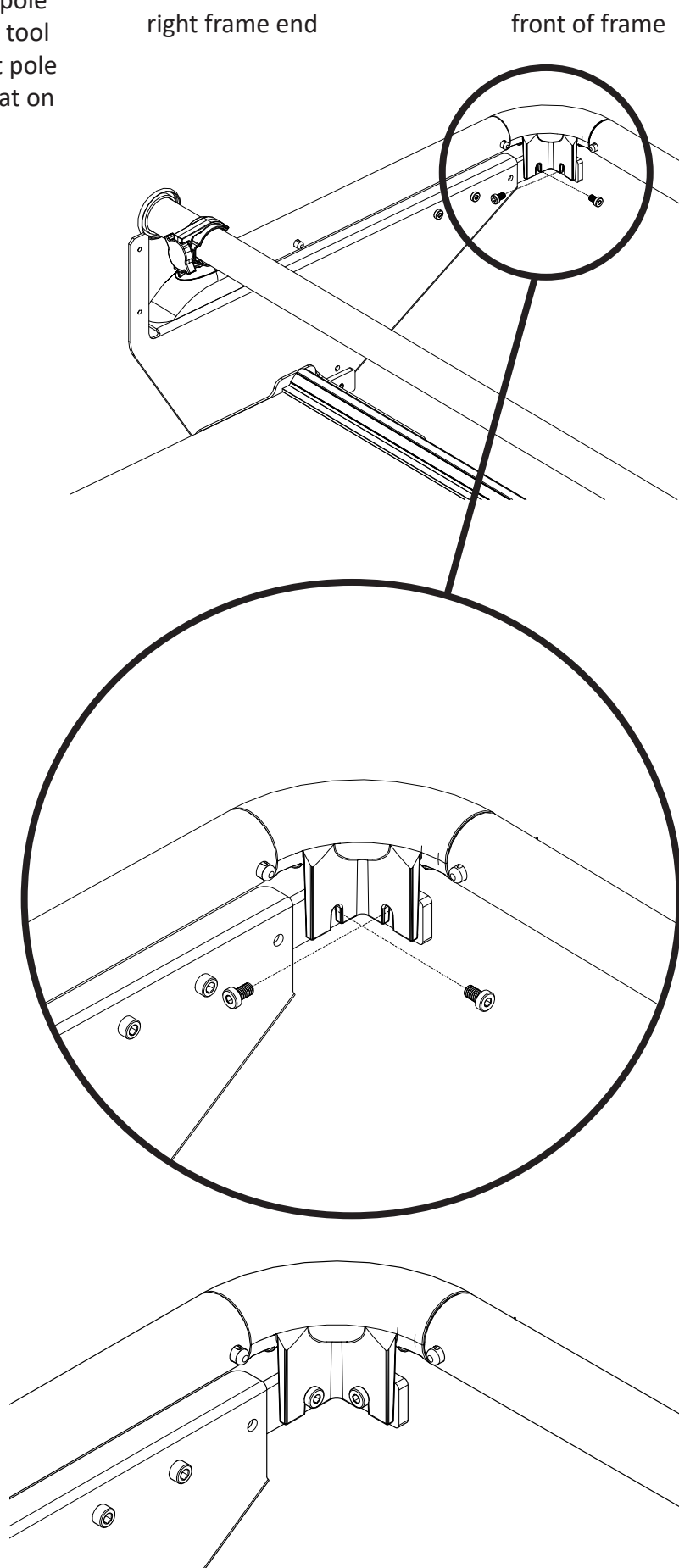

Set up for a King Quilter II Elite 16 machine

10. Insert two (2) M6 x 10mm socket cap screws into the holes on the inside of the front pole corner connector and use the 4 mm hex tool to tighten the screws to secure the front pole corner connector to the L-bracket. Repeat on the other side of the frame.

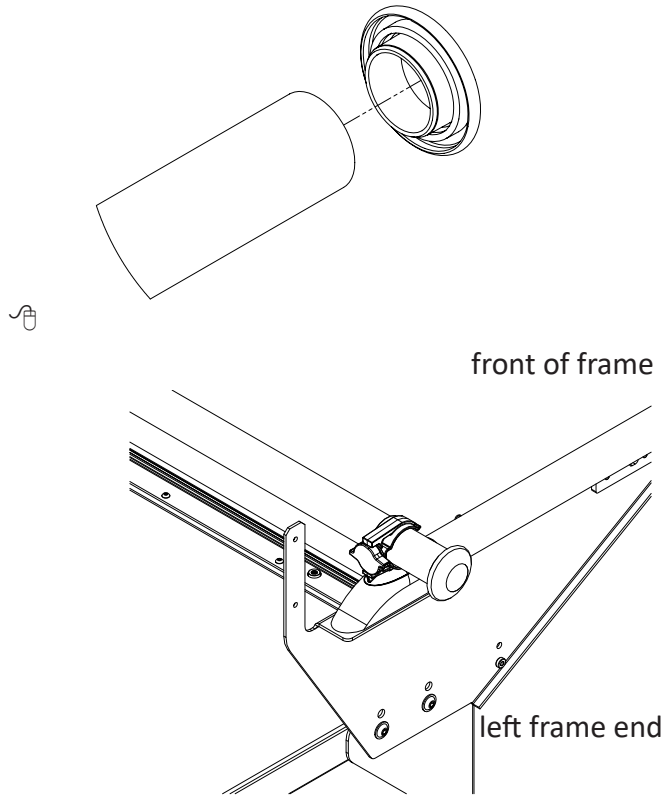

11. Assemble and attach the rear pole: Insert a rear pole end cap into each end of the rear pole. Attach the rear pole to the side arm clamps. Open the clamps by loosening the knob on the back. Then snap in the pole and tighten the knobs as needed.



 **NOTE:** When you put the carriage and quilting machine onto the frame, you will need to remove the rear pole temporarily and then replace the pole, placing it through the throat space of the machine.

## Aligning Track to Carriage

1. Loosen the three screws on each track through the large access holes on the bottom of the table top so the tracks can be moved freely.
2. Place the four-wheel carriage on the tracks. Ensure the distance between the front and rear tracks is correct and consistent for the wheels. Move the carriage along the track and slide the tracks closer or further apart as needed.
3. Once you have confirmed the tracks fit into the carriage wheels, align the back track straight across the rear of the frame and fully tighten the three screws.
4. Roll the carriage to one end, ensure the tracks are aligned the correct distance apart and fully tighten the front screw.
5. Repeat this process for the center and end screws at the front.

 **NOTE:** All screws should now be tightened and the machine should roll freely down the track without any resistance. If not, adjust the distance between the tracks until the carriage rides freely along the track.

 **NOTE:** Coarse adjustment is made with the large flange head screws from the underside of the table (**4mm hex tool**). Fine adjustment is made with the M4x4 button head screws on top of the track assembly (**2.5mm hex tool**).

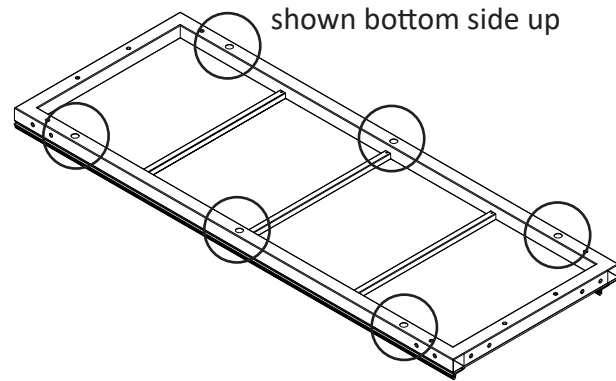

 **NOTE:** Access the three screws on each track from below the table top: one at the left, one in the center, and one at the right (circled above).

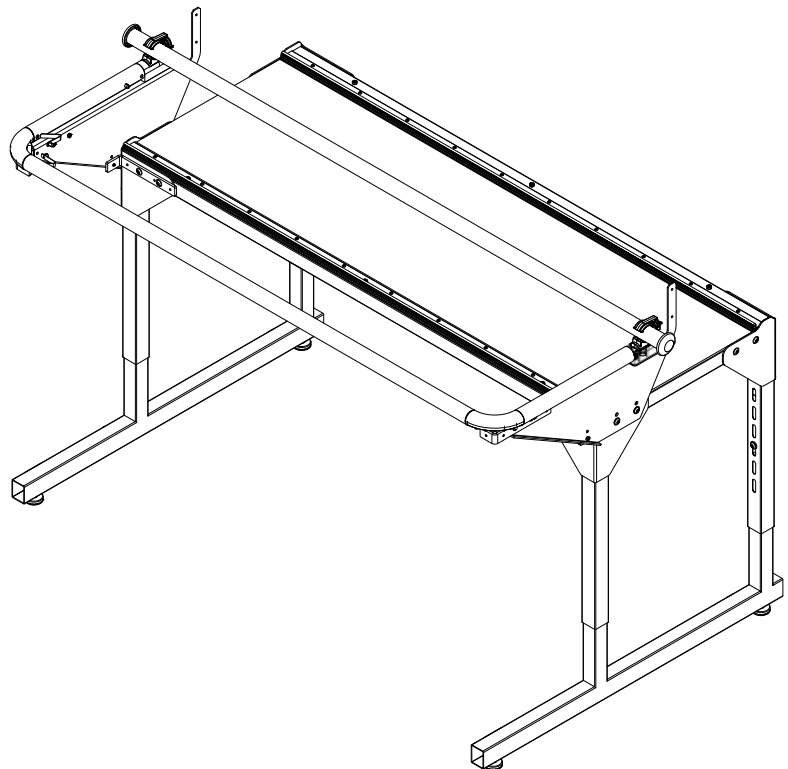

## Leveling and Setting Height

1. Level the frame: Using a spirit level and the machine, check and adjust the frame top to be level in the place where it will be used, both front to back and side to side, by adjusting the leveling feet. If no spirit level is available, check the table with the machine on the carriage and the tracks. When the table is level, the machine should stay where you put it and not roll forward, backward, or side to side.
2. Double check the frame height: Adjust the frame height so that when standing at the front of the machine with your hands on the front handle bars, your elbows are bent at a 90-degree angle. Refer back to step six under Table and Leg Assembly. Remove the machine and carriage from the frame. Then have a helper lift the frame weight off the height adjusting screws so you can make a height adjustment to both sides of the frame.