

Koalastudios™

Fine Sewing Furniture
— Crafted for You —

Owner's Manual



Congratulations

You are now the proud owner of a Koala Studio. A Koala Studio complements your style and your creativity. It's more than a home for your machine, it's a reflection of you.

Every detail of your Koala Studio – from the environmentally friendly, highest grade engineered wood base to the steel components and decorative handles – were chosen with quality, elegance and luxury in mind.

This owner's instruction manual will guide you through the care of your studio along with assembly instructions. After all, your studio is where you create and you should be able to do it easily and comfortably. Enjoy!

Hardware, Tools & Accessories

Included: Hand-Held Remote*, 1/2" Open Faced Wrench, #2 x 1-1/2" Screwdriver, Large Cam Lock Pins 1-1/4", Small Cam Lock Pins 5/8" and Shelf Support Pins 5/8"



Hand-Held Remote



Pull out of base and flip to use either Phillips or Flathead

Screwdriver



Small
Cam Lock
Pins 5/8"



Shelf Support Pins
5/8" for Adjustable
Shelf

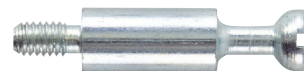

Large
Cam Lock Pins
1-1/4"

**Battery Replacement: Use a LRV08 Battery*

Contents

Moving Your Studio	2
Care and Cleaning	2
Lifts	3-4
Machine Insert Installation	5
Foot Rest Platform Installation	6
Outback Leaf Extension Installation	7

Moving Your Studio

When moving your Studio, be sure to remove door shelves and Outback shelves, lower the Outback leaf and close the doors.

Koala casters are meant for positioning your Studio inside your home - they are not designed for rolling on sidewalks or driveways, or over door frames. Ensure caster latch is in the unlocked up position when moving your studio. The casters may be locked; latch in the downward position when your studio is in place. When moving your Studio in or out of your home, it should be team-lifted and carried or moved on furniture dollies.



LOCKED



UNLOCKED

Care & Cleaning

Your Koala Studio may be cleaned with a damp cloth, then wiped dry. If necessary, mild soap and water may be used. Do not use oils, waxes, bleach or abrasives. Don't place near sources of moisture. Avoid setting anything hot on the tabletop. Keep your Koala furniture in a climate controlled environment. Avoid extreme temperature changes and prolonged direct sunlight.

Lifts

Koala Studios' innovative lift design enables you to effortlessly position your machine at any level with just the push of a button. The remote control can stop the machine in any position with no effort. The machine platform remains solid and steady while evenly supporting your machine in every position.

Operates with a hand-held remote control or built-in toggle switch. The Koala **XL-Lift** safely supports the largest, heaviest, top-of-the-line sewing and quilting machines.



Hand Held Remote or Built-In Toggle Switch



1) Hand-held ergonomically designed remote control. Battery included.



2) To operate the hand-held remote, switch the remote control power button on the front of the control box to the "on" position.

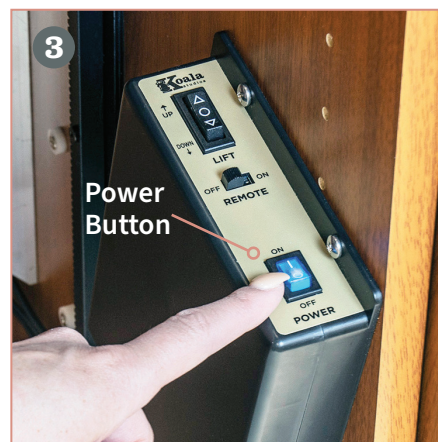

3) The Lift operates with the hand-held remote control or a built-in toggle switch. Each operates with a simple up/down button that raises and lowers the lift and machine.

Note: When the Power switch is in the "on" position, it is lit in blue. To save energy it is recommended to turn the Power Switch "off" when not operating the Glide Lift.

4



4) The Glide Lift can stop at any level (*shown in stored position with filler board in place*).

5



5) With the filler board removed, your lift can be raised or lowered.

6



6) This shows the machine positioned level with the Studio top surface with a custom machine insert in place for sewing and quilting. ***For embroidery and free-arm applications the machine should be positioned at the top level.***

7



7) When filler board is not in use it can be stored underneath your studio.

Machine Insert Installation

Studio Inserts are designed to fit your specific make and model of sewing machine and studio. The Insert fills the gap between the sewing machine and the opening of the studio to create a flat working surface.



1) Remove filler board before raising your machine. Remove all accessory trays surrounding the machine’s free arm.



2) Adjust the studio lift so the needle plate area of the free arm is level with the top of the studio. The insert will not fit if the machine is too high.

Height is Incorrect if: The insert is raised while resting against the machine. The free arm is higher than the insert. (Lower the lift).

Height is Correct if: Insert sits flush and level with the needle and studio.



3) Place insert around the machine and lay in studio. This is the correct fit.

Refer to troubleshooting chart for fit issues.

Machine Insert Trouble Shooting

Troubleshooting Insert Fit Issues	Reason	Solution
Machine won’t fit around arm	Accessory tray is attached	Remove tray
Insert won’t fit flush	Studio lift is too high	Lower lift
Insert sits up and over the machine	The machine has a downward sloped or curved sewing surface to the right of the machine	This is the correct fit (Fig. 3)
Table or insert still won’t fit		Contact your Koala Retailer

Foot Rest Platform Installation

The adjustable Foot Rest Platform is designed to position your sewing machine foot rest at a comfortable height. It fits on top of the base of the studio. (Your studio can also be used without the Foot Rest).

1



Underside of Foot Rest Platform

1) Choose the height that best suits your needs. (*Base by itself, 1-3/4", 2-3/4" or 3-3/4"*). Screw in your platform supports (*clockwise*) into the holes on the bottom of the Foot Rest Platform.

2



2) With all five platform supports in place carefully slide into the bottom base of your studio as shown.



Note: Platform supports must be removed to store under the cabinet.

Outback Leaf Assembly

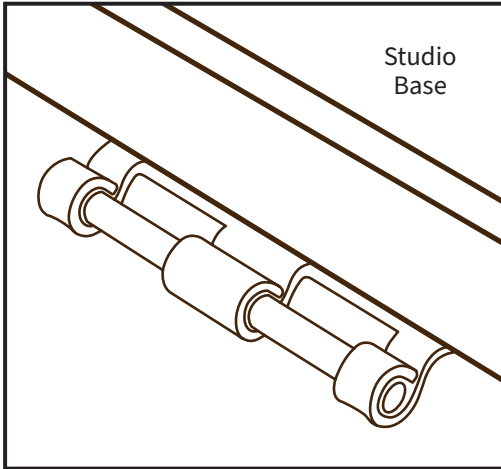

Studio
Base

Outback Leaf Gravity Hinge (**Mounted on studio base**)

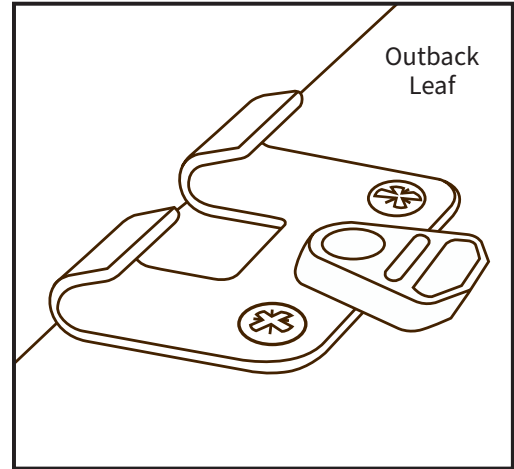

Outback
Leaf

Outback Leaf Gravity Hinge Unlocked (**Mounted on
outback leaf**)

Install Outback Leaf Two People Required

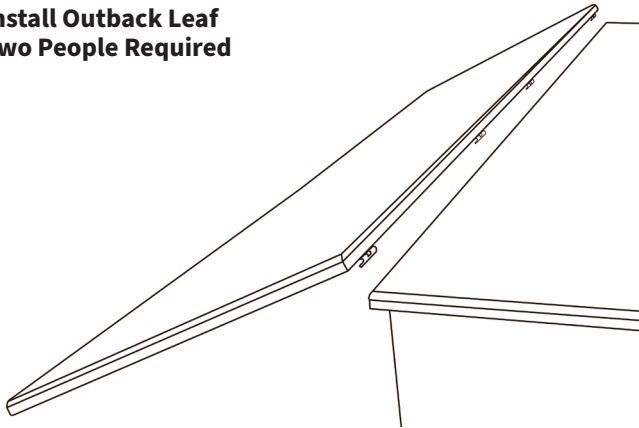

- Leaf has been disassembled for shipping.
- The hinge base has been mounted to the backside of the Studio Top Panel and the hinge hook has been mounted to the Outback Leaf.
- Lower the Outback Leaf into position by setting the hook portion on to the base as shown in view.

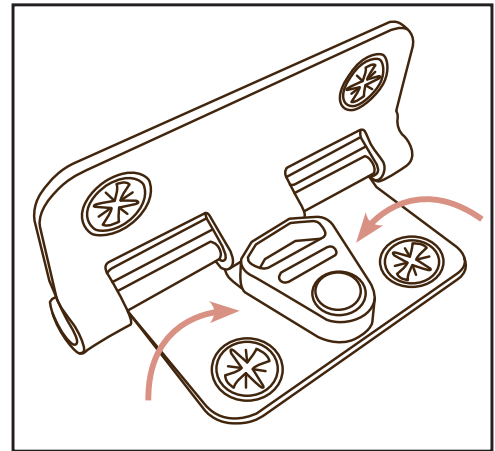

Outback Leaf Gravity Hinge Locked
**Lock Hinge After Outback Leaf
Installed. 4-5 Locations Total,
depending on model.**

KoalaTM

s t u d i o s

www.koalacabinets.com

KoalaTM

s t u d i o s

www.koalacabinets.com

Koala furniture is assembled with globally sourced parts. Koala Studios are manufactured and distributed by Tacony Corporation.

Brought to You by Tacony Corporation®.



Fine Sewing Furniture

— Crafted for You —

Koala Studios are beautifully designed and assembled for you in the Midwest. Built with the finest materials, these luxury spaces feature structural elements and configuration options that support all brands of machines and sewing genres. Koala's exclusive ergonomic design inspires mastery and comfort while meeting the individual needs of your personal studio space. Choose your configuration and color, and Koala will build the studio of your dreams.