

## **TABLE ASSEMBLY HELP IMAGES**



**Step One:**

**Lay table top upside down and layout side and center pieces**



**Step 2:**

**When laying out center extension tubes be sure that the holes on the ends are facing out**



**Step 3:**

Place each center bracket into its left and right tubes and use 8 of the M6 screws to attach the L & R tubes to the extension tube

\*Avoid excessive tightening

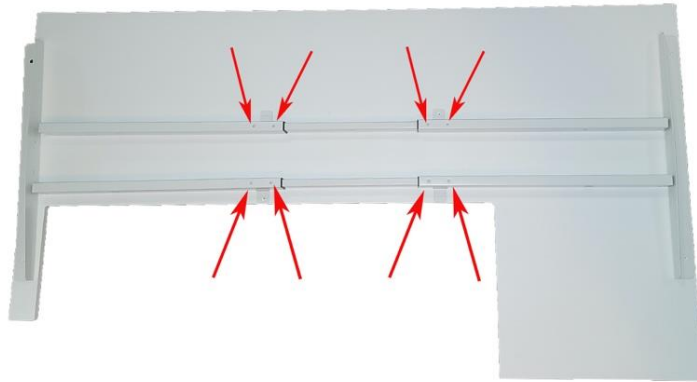

**Step 4:**

Attach columns into the place which is between the left and right tubes.

\*avoid excessive tightening of the screws

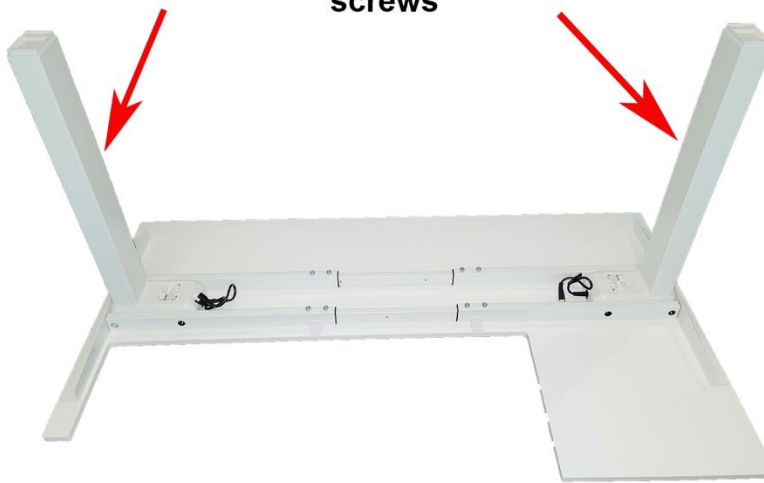

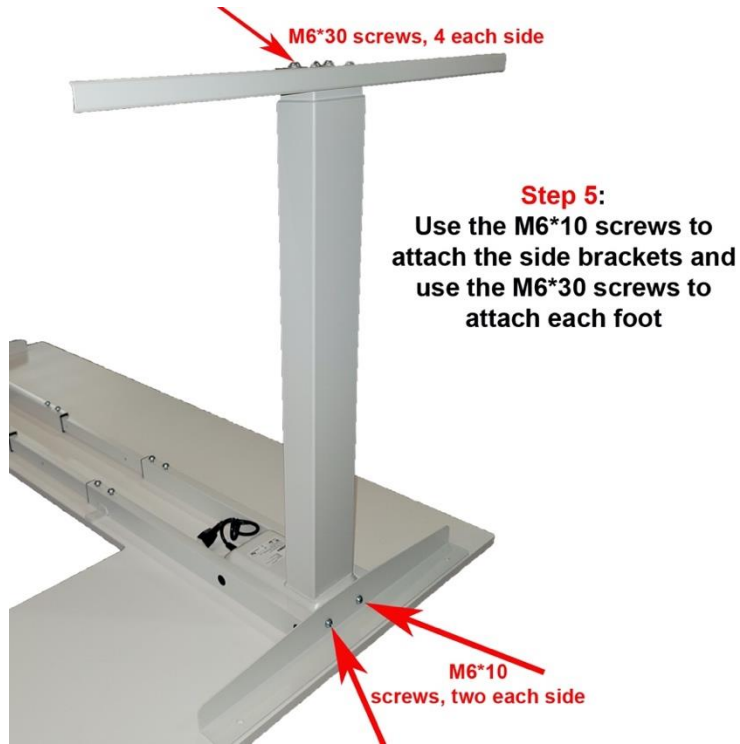

**Step 6:**  
Attach the frame to the table top using 8 of the ST4.8\*16 tapping screws then attach the handset using 2 the ST3.5\*16 tapping screws



**Step 8:**  
Attach the power adapter  
and power cord  
\*do not fasten the cable clip on  
this step



**Step 9:**

Attach the power cords for the motors on each column. If you would like you can add a third cable clip in the center of the table. Extend one of the column cables to the power box and then close that cord and the power box cord in the left cable bracket. Close the cable bracket on the right side of the power box as well

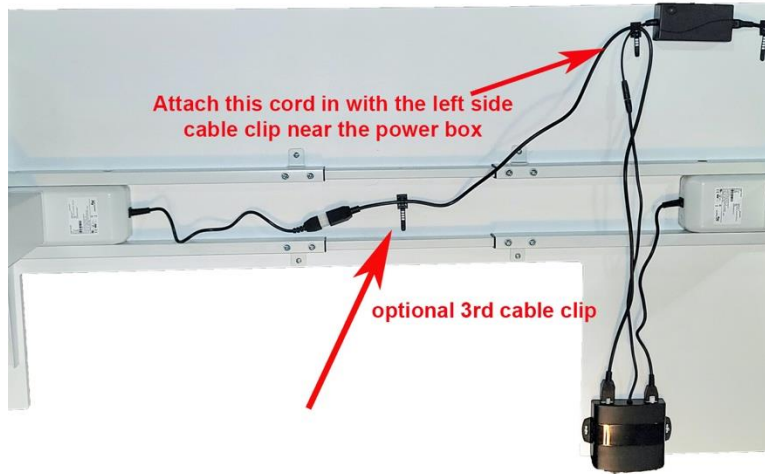

**Step 10:**

Flip your table over and plug it in!  
Repeat the process for the second table

