

*Embroider
&
Shine*

Jewelry



The specially designed "Embroider & Shine" collection is made of 5 units in various shapes to give you unlimited variety! You can find them, plus 3 ready-made combinations, as free downloads at husqvarnaviking.com/shine.

You need:

- HUSQVARNA VIKING® sewing and embroidery machine
 - HUSQVARNA VIKING® Embroider & Shine designs
 - Inspira Aqua Magic Water soluble stabilizer #620114396
 - Embroidery thread of your choice. We used Robison Anton Rayon 40:2224, 2296, 2380, 2430, 2521
 - Ribbon 1cm (3/4") wide, silk or organza, 80cm (31") long, matching your jewelry
 - Kandi Corp Swarovski® Hot Fix crystals 5mm
 - Kandi Corp Professional Touch Applicator
1. Hoop the stabilizer in the HUSQVARNA VIKING® Large Embroidery Hoop 240x150mm (9.6" x 6").
 2. Embroider the #XX design in the color of your choice.
 3. Soak the designs in water, just enough to make the stabilizer dissolves.
 4. Set aside to dry.
 5. Iron the necklace to get it flat.
 6. Cut the ribbon in half and sew on with the sew-on-button stitch.
 7. Add Swarovski® Hot Fix crystals by using the Kandi Corp Professional Touch Applicator, detailed instructions can be found on the package.



You need:

- HUSQVARNA VIKING® sewing and embroidery machine
 - HUSQVARNA VIKING® Embroider & Shine designs
 - Inspira Aqua Magic Water soluble stabilizer #620114396
 - Embroidery thread of your choice. We used Robison Anton Rayon 40: 2224, 2296, 2342, 2380, 2430, 2521
 - Ribbon 1cm (3/4") wide, silk or organza, 80cm (31") long, matching your jewelry
 - Fish hook earrings
 - Kandi Corp Swarovski® Hot Fix crystals 5mm
 - Kandi Corp Professional Touch Applicator
1. Hoop the water soluble stabilizer in the HUSQVARNA VIKING® Large Embroidery Hoop 240x150mm (9.6" x 6").
 2. Embroider the designs in the color of your choice.
 3. Soak the embroidered jewelry elements in water, just enough to make the stabilizer dissolve.
 4. Set aside to dry.
 5. After the pieces are dry, press with an iron to make them flat
 6. Arrange the elements in a pleasing design and sew them together with the sew-on-button stitch. This stitch is sewn without any presser foot. Add a ribbon with the same stitch.
 7. For earrings, add a fish hook earring in the eyelet of the embroidery.
 8. Add Swarovski® Hot Fix crystals by using the Kandi Corp Professional Touch Applicator, detailed instructions can be found on the package.

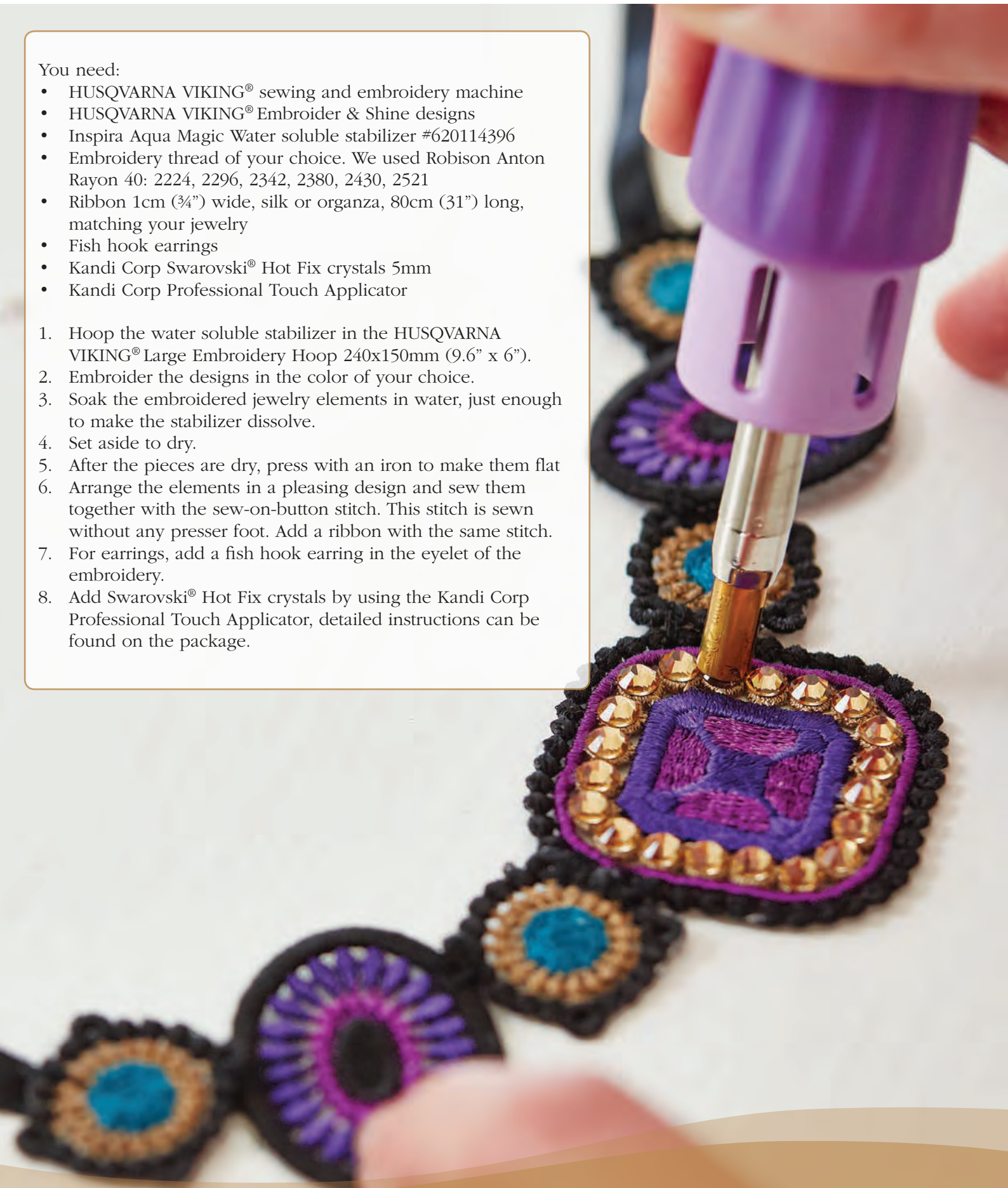

More inspiration

Earrings



On some of the embroideries you can choose to embroider the loop or not. This irregular unit gets a slightly different look depending on which loop you choose for attaching the hook.



Create earrings from single units, or - combine them with each other!



Combinations for Bracelets



Combinations for necklaces



Possible combinations for accessories and home decoration

